

United States Department of the Interior
National Park Service

NR LISTED
NOV 18 1999
AHPP

NATIONAL REGISTER OF HISTORIC PLACES
REGISTRATION FORM

=====

1. Name of Property

=====

Historic Name: Art Scanlan House

Other Name/Site Number: (VB0051)

=====

2. Location

=====

Street & Number: Route 1, West of U.S. Hwy 65 behind Bee Branch Fire Station and North of Bee Branch Cemetery

Not for Publication: N/A

City/Town: Bee Branch

Vicinity: N/A

State: AR County: Van Buren Code: AR141 Zip Code: 72013

=====

3. Classification

=====

Ownership of Property: private

Category of Property: building

Number of Resources within Property:

Contributing	Noncontributing	
<u>1</u>	<u>1</u>	buildings
<u> </u>	<u> </u>	sites
<u> </u>	<u> </u>	structures
<u> </u>	<u>1</u>	objects
<u>1</u>	<u>2</u>	Total

Number of contributing resources previously listed in the National Register: N/A

Name of related multiple property listing: N/A

4. State/Federal Agency Certification

As the designated authority under the National Historic Preservation Act of 1986, as amended, I hereby certify that this X nomination request for determination of eligibility meets the documentation standards for registering properties in the National Register of Historic Places and meets the procedural and professional requirements set forth in 36 CFR Part 60. In my opinion, the property X meets does not meet the National Register Criteria. See continuation sheet.

Signature of certifying official [Handwritten Signature]

Date 9-30-99

Arkansas Historic Preservation Program

State or Federal agency and bureau

In my opinion, the property meets does not meet the National Register criteria. See continuation sheet.

Signature of commenting or other official

Date

State or Federal agency and bureau

5. National Park Service Certification

I, hereby certify that this property is:

- entered in the National Register
See continuation sheet.
determined eligible for the National Register
See continuation sheet.
determined not eligible for the National Register
removed from the National Register

other (explain):

Signature of Keeper

Date of Action

6. Function or Use

Historic: Domestic Sub: Single Dwelling

Current : Domestic Sub: Single Dwelling

7. Description

Architectural Classification:

other: Folk Victorian

Materials: foundation STONE roof METAL
walls Weatherboard other BRICK

Describe present and historic physical appearance:

Summary

Built circa 1906, the Art Scanlan House is a demure one-story Folk Victorian residence. A concrete and field stone foundation supports the weatherboard-clad frame walls. Two symmetrically placed brick interior end chimneys grace the roofline. Originally covered in wood shingles, the gable-on-hip roof is now covered by corrugated metal. Fortunately, despite the addition of the corrugated metal the original roof cresting, with shamrock cut-outs, remains. Oral tradition states the shamrock pattern is a reminder of the original owner's Irish heritage. The cottage is sited on a hill west of U.S. Route 65 in the town of Bee Branch and access is gained to the property by an unnamed gravel road. Also located on the property are a modern concrete swimming pool and a garage; neither contribute to the nomination.

Elaboration

The front, or eastern, elevation is distinguished from the high-styled Queen Anne Victorian by its strict symmetry and simplicity. Access is gained to the porch by concrete and fieldstone stairs. At an unknown date the original Tuscan columns and turned-spindle balusters were removed from the front porch. The

three quarter length porch is now supported by four paneled box columns and a turned spindle balustrade. During the recent restoration, a limited number of the original spindles were discovered in the attic and used to recreate the appearance of the original balustrade. The owner intends to complete the balustrade restoration by reproducing the missing spindles.

Above the front porch, the eastern elevation is dominated by a centered cross gable wall dormer with jigsawn verge detail and a rectangular wood louvered vent. Originally, the cross gable featured a small lunette window divided into four lights. An ovular light door flanked by sidelights is also centered on this elevation, strengthening the symmetry of the design (this single leaf door is of modern design). A pair of windows is located on either side of the first floor of this elevation. With but a few exceptions, all windows are double-hung one-over-one windows.

The northern elevation is dominated by a three-sided beveled bay projection with three windows. Above the bay projection in the gable is a small amount of gingerbread detailing similar to that found on the front elevation. The rest of the elevation contains the gable-roofed L-projection and is fenestrated by a pair of windows and two smaller single windows.

The rear, or western elevation has been converted from a porch to a family room. This has become the preferred entrance to the residence and has a modern window and door. The southern portion of this room has a modern patio door leading to the pool area.

Unlike the northern elevation the southern elevation is relatively simple and contains a pair of modern French doors and a window. Above in the gable end of the gable-on-hip is a small amount of jigsawn detail.

The interior is rather plainly adorned, but does feature multiple-pane, double-leaf French doors between the entry hall (east elevation) and south bedroom. These same type French doors are also located on the south wall of the bedroom and lead to the pool area. Other details of note are the interior doors which have the original transoms and original hardware.

The garage/storage building and the concrete swimming pool are both non-historic and do not contribute to the nomination.

=====
8. Statement of Significance
=====

Certifying official has considered the significance of this property in relation to other properties: local_____.

Applicable National Register Criteria: C_____

Criteria Considerations (Exceptions): N/A_____

ART SCANLAN HOUSE

Name of Property

Van Buren, AR

County and State

Areas of Significance: ARCHITECTURE

Period(s) of Significance: c. 1906

Significant Dates: c. 1906

Significant Person(s): N/A

Cultural Affiliation: N/A

Architect/Builder: Unknown

State significance of property, and justify criteria, criteria considerations, and areas and periods of significance noted above:

Summary

The Art Scanlan House is significant locally under Criterion C as a well-maintained example of a small Folk Victorian style house with its a gable-on-hip roof, an unusual feature among buildings designed in this style. With this in mind, the Collums-Baker House (NR listed 11/24/92) in the Bee Branch vicinity also displays this particular roof pattern. Future research may confirm the two houses share a common builder. What sets the Art Scanlan House apart from the Collums-Baker is the abundance of original detail and ornament, including the verge trim on the northern, southern and eastern elevations, the metal roof cresting, and the location of the two small brick chimneys that rise through the ridge. The unusual roofline and all of these features combine to make the Art Scanlan House locally significant and worthy of National Register listing.

Elaboration

The Art Scanlan House was built in 1906 for Art Scanlan and his new bride, Myrtle Maddox Scanlan. The house was a wedding gift from Art's father, J. E. Scanlan, who had built the first frame residence in Bee Branch in about 1881. Art's residence remained in the Scanlan family until 1947. It is now owned and occupied by Jimmy Don and Carolyn Bradford.

The area around the modern community of Bee Branch was settled circa 1830 by pioneers from Tennessee, Kentucky, Mississippi, Alabama, and the Carolinas. More

accurate information is unavailable due to the loss of all records in the Van Buren County Courthouse fire of 1859. After the Civil War, several families from Illinois and Kansas moved to the Bee Branch area along with a few settlers from Tennessee, Georgia, and Alabama. The next major wave of immigration came in 1873, when four families from Newburg, Mississippi stopped their oxen-pulled wagons in Bee Branch and decided to abandon their westward journey and settle in the area. The first mention of any mercantile activity in the area occurred in 1881-1882 when J. E. Scanlan arrived in a slatted "chicken or peddling" wagon. According to A History of Van Buren County, Scanlan "put up a second store in Bee Branch, having a line of pins, thread, buttons, notions, and a few bolts of cloth." Coinciding with this development, the post office was moved from Cross Roads to a new log house in Bee Branch, where it remained until 1975.

The Art Scanlan House is significant locally under Criterion C as the best example, within the town of Bee Branch, of a small Folk Victorian style house with a gable-on-hip roof, the verge trim on the northern, southern and eastern elevations, and metal shamrock patterned roof cresting. The unusual roofline and all of these features combine to make the Art Scanlan House locally significant and worthy of National Register listing.

=====

9. Major Bibliographical References

=====

A History of Van Buren County, Arkansas. Conway: River Road Press, 1976.

Correspondence with Bill Maddox, February 22, 1997.

Interview with Mary Helen Baker, May 21, 1997.

Interview with Nica Evans, May 1999.

Previous documentation on file (NPS):

- _ preliminary determination of individual listing (36 CFR 67) has been requested.
- _ previously listed in the National Register
- _ previously determined eligible by the National Register
- _ designated a National Historic Landmark
- _ recorded by Historic American Buildings Survey # _____
- _ recorded by Historic American Engineering Record # _____

ART SCANLAN HOUSE

Van Buren, AR

Name of Property

County and State

Primary Location of Additional Data:

- State historic preservation office
- Other state agency
- Federal agency
- Local government
- University
- Other -- Specify Repository: _____

=====

10. Geographical Data

=====

Acreage of Property: approximately two acres

UTM References: Zone Easting Northing Zone Easting Northing

A 15 555000 3922660 B _____

C _____ D _____

Verbal Boundary Description:

PART OF THE SOUTH HALF OF THE NORTHEAST QUARTER (PT. S1/2 NE1/4), SECTION FIVE (5), TOWNSHIP NINE (9) NORTH, RANGE THIRTEEN (13) WEST, MORE PARTICULARLY DESCRIBED AS: STARTING AT AN IRON STAKE AT THE SE CONRER OF THE SE1/4 NE1/4, THENCE WEST 11295.45 FEET ALONG WITH SOUTH LINE OF SE1/4 NE1/4 TO THE POINT OF BEGINNING OF THE PARCEL HEREIN DESCRIBED, THENCE WEST ALONG THE SOUTH LINE OF SAID SE1/4 NE1/4 12/39 FEET TO A POINT, THENCE N 32 DEGREES 27'17" W 216.91 FEET TO A POINT IN SW1/4 NE1/4, SAID POINT BEING IN THE APPROXIMATE LINE OF A ROADWAY, THENCE N 22 DEGREES 18' E 145.0 FEET ALONG SAID ROADWAY TO CENTER LINE OF A ROADWAY, THENCE N 22 DEGREES 18' E 145.0 FEET ALONG SAID ROADWAY TO A POINT, THENCE LEAVING SAID ROADWAY AND RUN N 31 DEGREES 48' E 45.0 FEET TO A POINT, THENCE S 56 DEGREES 07' W 287.04 FEET TO THE POINT OF BEGINNING, CONTAINING 2.00 ACRES, MORE OR LESS, TOGETHER WITH HOME LOCATED THEREON.

ART SCANLAN HOUSE

Name of Property

Van Buren, AR

County and State

Boundary Justification:

This boundary contains all the property historically associated with the Art Scanlan House.

=====

11. Form Prepared By

=====

Name/Title: Amy Bennett/Survey Historian

Organization: Arkansas Historic Preservation Program Date: 9/29/99

Street & Number: 1500 Tower Bldg., 323 Center St. Telephone: (501) 324-9880

City or Town: Little Rock State: AR ZIP: 72201

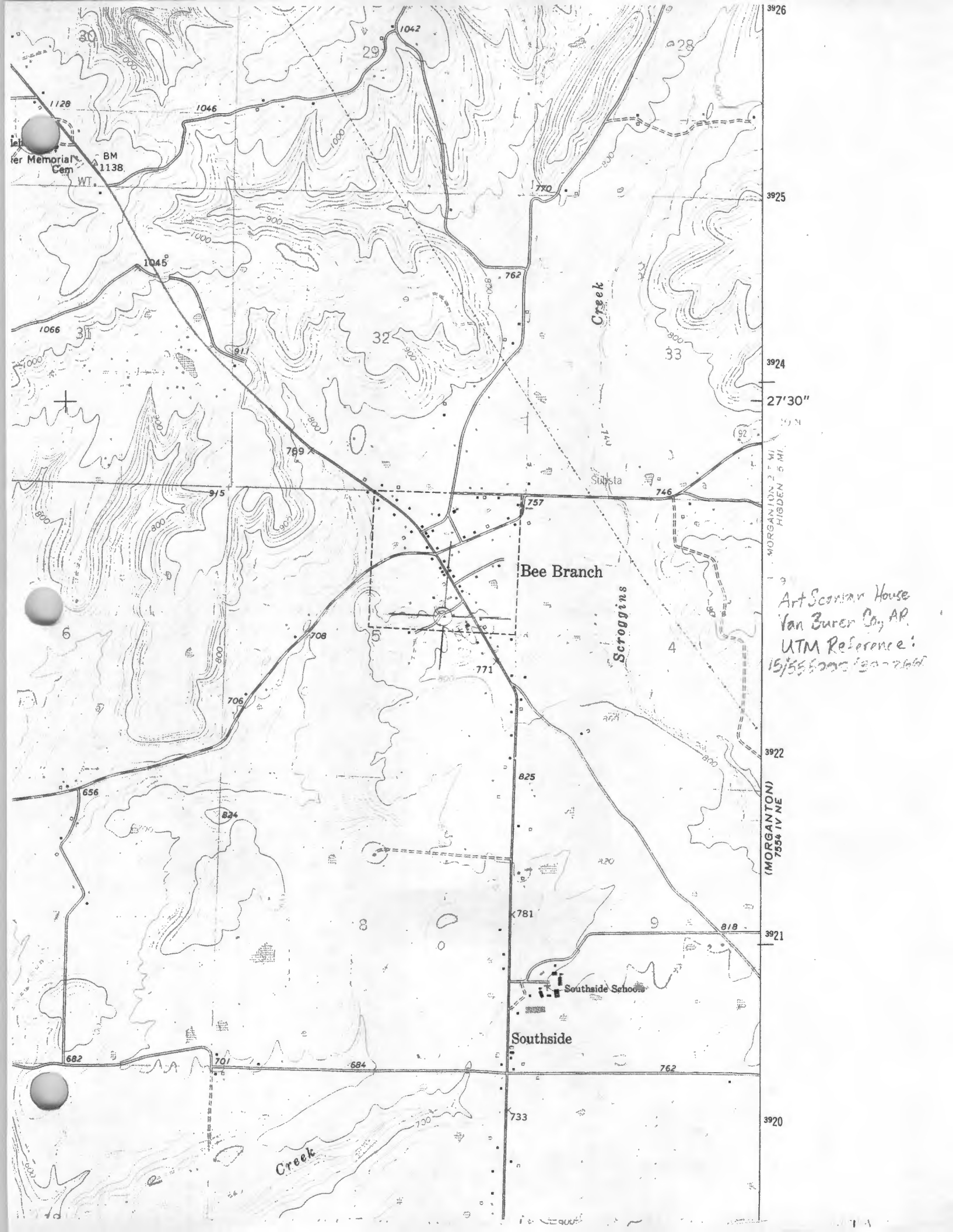

Memorial Cem
BM 1138

Bee Branch

Creek

Scroggins

Southside School

Southside

3926

3925

3924

27'30"

19 N

MORGANTON 27 MI
HIDDEN 5 MI

3922

(MORGANTON)
7554 IV NE

3921

3920

Art Scanlan House
Van Buren Co, AR.
UTM Reference:
15J555000 3922600









