

NR LISTED

OCT 31 1996

United States Department of the Interior
National Park Service

NATIONAL REGISTER OF HISTORIC PLACES
REGISTRATION FORM

AHPP

1. Name of Property

historic name: Myers House

other name/site number: PH0274

2. Location

street & number: 221 St. Andrew's Terrace

not for publication: N/A

city/town: West Helena

vicinity: N/A

state: AR county: Phillips code: AR 107 zip code: 72390

3. Classification

Ownership of Property: Private

Category of Property: Building

Number of Resources within Property:

Contributing	Noncontributing	
<u>1</u>	<u> </u>	buildings
<u> </u>	<u> </u>	sites
<u> </u>	<u> </u>	structures
<u> </u>	<u> </u>	objects
<u>1</u>	<u>0</u>	Total

Number of contributing resources previously listed in the National Register: N/A

Name of related multiple property listing: Historic Resources of West Helena, Arkansas, 1900-1945

Myers House
Name of Property

Phillips County, AR
County and State

=====
4. State/Federal Agency Certification
=====

As the designated authority under the National Historic Preservation Act of 1986, as amended, I hereby certify that this X nomination _____ request for determination of eligibility meets the documentation standards for registering properties in the National Register of Historic Places and meets the procedural and professional requirements set forth in 36 CFR Part 60. In my opinion, the property X meets _____ does not meet the National Register Criteria. _____ See continuation sheet

Carolyn A. Slater
Signature of certifying official

9-4-96
Date

Arkansas Historic Preservation Program
State or Federal agency and bureau

In my opinion, the property X meets _____ does not meet the National Register criteria. _____ See continuation sheet.

Signature of commenting or other official

Date

State or Federal agency and bureau

=====
5. National Park Service Certification
=====

I, hereby certify that this property is:

- _____ entered in the National Register _____
_____ See continuation sheet.
_____ determined eligible for the National Register _____
_____ See continuation sheet.
_____ determined not eligible for the National Register _____
_____ removed from the National Register _____
_____ other (explain): _____

Signature of Keeper Date of Action

Myers House
Name of Property

Phillips County, AR
County and State

=====

6. Function or Use

=====

Historic: DOMESTIC Sub: Single dwelling

Current: DOMESTIC Sub: Single dwelling

=====

7. Description

=====

Architectural Classification:

Craftsman
Prairie

Other Description: N/A

Materials: foundation Brick roof Asphalt
walls Brick other N/A

Describe present and historic physical appearance. See continuation sheet.

Description

The Myers House (at 221 St. Andrew's Terrace) is a two-and-one-half story, wood frame and brick masonry residence designed in a synthesis of the Craftsman and Prairie styles. The main two-story block of the house is fundamentally rectangular, though its design is augmented with a single-story hipped sunroom on its southern elevation and a 2/3 porch at its northeast corner, supported upon brick columns. The asphalt shingle hipped roof features a total of three broad dormers on each of its eastern, northern and southern slopes, as well as a single-story, hipped bay projecting from the northern elevation directly below the dormer. The single-story hipped rear section appears to have been modified at some point, possibly by the filling of an originally open porch. One tall brick chimney rises next to the southern wall, and another rises through the western or rear slope of the main hipped roof. The windows throughout are largely one-over-one wood frame, and the entire structure is supported upon a continuous brick foundation.

Myers House
Name of Property

Phillips County, AR
County and State

=====
8. Statement of Significance
=====

Certifying official has considered the significance of this property in relation to other properties: Locally

Applicable National Register Criteria: C

Criteria Considerations (Exceptions): N/A

Areas of Significance: ARCHITECTURE

Period(s) of Significance: c. 1920

Significant Dates: c. 1920

Significant Person(s): N/A

Cultural Affiliation: N/A

Architect/Builder: Unknown

State significance of property, and justify criteria, criteria considerations, and areas and periods of significance noted above.
___ See continuation sheet.

Significance Criterion C, local significance

The Myers House (at 221 St. Andrew's Terrace) is locally significant under Criterion C by virtue of its status as the best example of a combination of the Craftsman and Prairie styles in West Helena. Constructed just south of the ninety-degree turn at the eastern end of Plaza Avenue in one of the residential areas of the city developed slightly later than those sections immediately to the west, it is associated with the historic context *Historic Resources of West Helena, Arkansas, 1900-1945* as one of the few surviving historic homes with any degree of integrity, and as the best known extant example of this synthesis of popular national styles.

Myers House
Name of Property

Phillips County, AR
County and State

=====

9. Major Bibliographical References

=====

See "Historic Resources of West Helena, Arkansas, 1900-1945," Section H.

___ See continuation sheet.

Previous documentation on file (NPS):

- preliminary determination of individual listing (36 CFR 67) has been requested.
- previously listed in the National Register
- previously determined eligible by the National Register
- designated a National Historic Landmark
- recorded by Historic American Buildings Survey # _____
- recorded by Historic American Engineering Record # _____

Primary Location of Additional Data:

- X State historic preservation office
- Other state agency
- Federal agency
- Local government
- University
- Other -- Specify Repository: _____

=====

10. Geographical Data

=====

Acreage of Property: Less than one

UTM References:	Zone	Easting	Northing	Zone	Easting	Northing
A	<u>15</u>	<u>717180</u>	<u>3824465</u>	B	<u>15</u>	_____
C	<u>15</u>	_____	_____	D	<u>15</u>	_____

___ See continuation sheet.

Verbal Boundary Description: ___ See continuation sheet.

Beginning at a point formed by the intersection of the western edge of St. Andrew's Terrace with a perpendicular line running parallel with the building's southern elevation and located approximately 50 feet to the south thereof, proceed westerly along said line for approximately 200 feet; thence proceed northerly along a perpendicular line for approximately 200 feet; thence proceed easterly along a perpendicular line for approximately 200 feet to its intersection with the western edge of St. Andrew's Terrace; thence proceed southerly along said edge to the point of beginning.

Boundary Justification: ___ See continuation sheet.

Myers House
Name of Property

Phillips County, AR
County and State

his boundary includes all the property historically associated with this resource that retains its integrity.

=====
11. Form Prepared By
=====

Name/Title: Ken Story, National Register/Survey Coordinator
Organization: Arkansas Historic Preservation Program Date: 09/03/96
Street & Number: 323 Center Street, Suite 1500 Telephone: (501) 324-9880
City or Town: Little Rock State: AR Zip: 72201



HISTORICAL RESOURCES
 OF HELENA,
 ARKANSAS
 WEST HELENA,
 PHILLIPS CO., AR

PH0270
 15/716530/
 3825000

PH0271
 15/715100/
 3824800

PH0272
 15/717180/
 3824245

PH0273
 15/717180/
 3824320

PH0274
 15/717180/
 3824465

PH0275
 15/717140/
 3824760

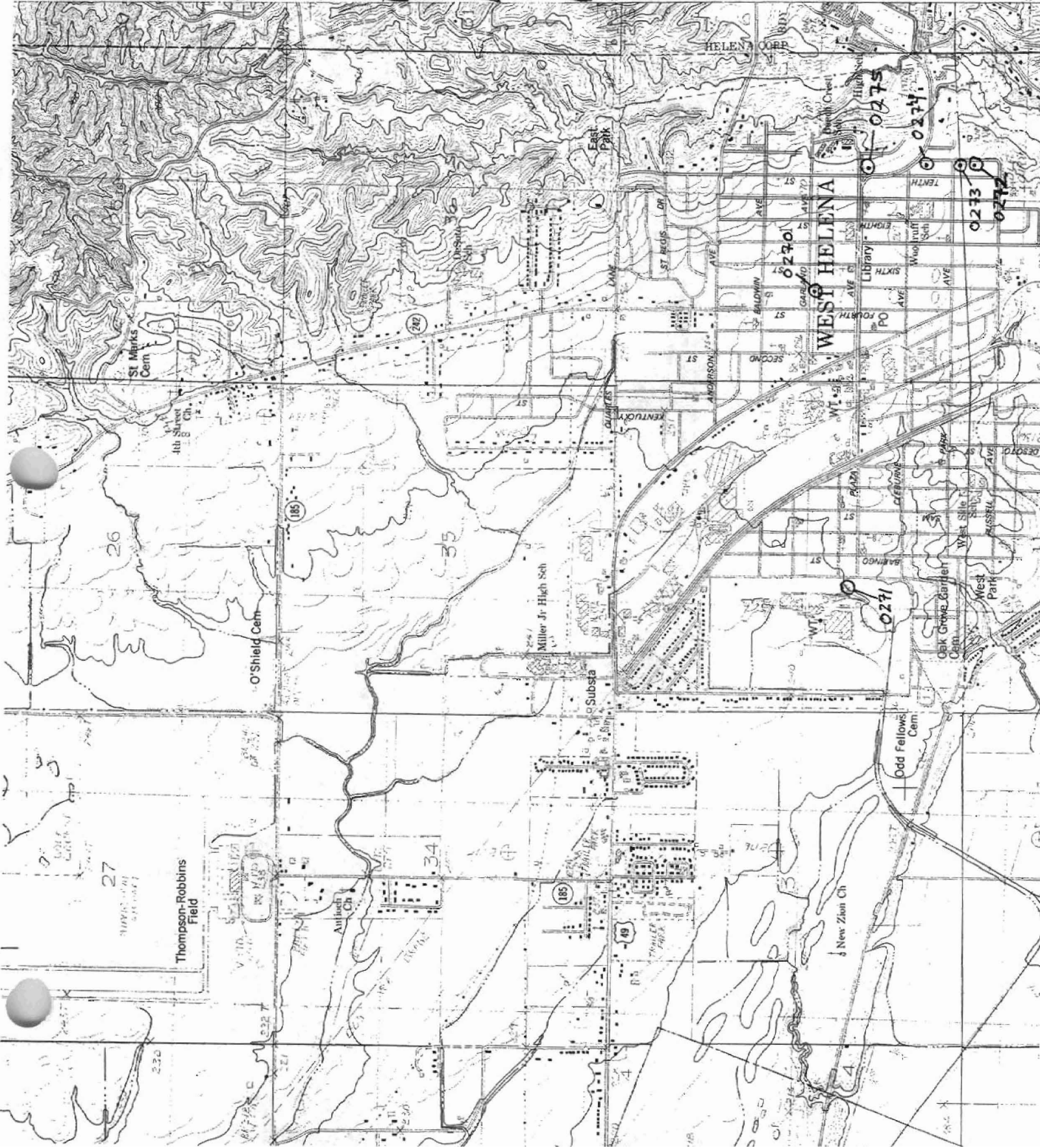

3825
 32' 30"
 3824