

NR LISTED

OCT 31 1996

United States Department of the Interior
National Park Service

NATIONAL REGISTER OF HISTORIC PLACES
REGISTRATION FORM

AHPP

1. Name of Property

historic name: Gemmill-Faust House

other name/site number: PH0272

2. Location

street & number: 321 St. Andrew's Terrace

not for publication: N/A

city/town: West Helena

vicinity: N/A

state: AR county: Phillips code: AR 107 zip code: 72390

3. Classification

Ownership of Property: Private

Category of Property: Building

Number of Resources within Property:

Contributing	Noncontributing	
<u>2</u>	<u> </u>	buildings
<u> </u>	<u> </u>	sites
<u> </u>	<u> </u>	structures
<u> </u>	<u> </u>	objects
<u>2</u>	<u>0</u>	Total

Number of contributing resources previously listed in the National Register: N/A

Name of related multiple property listing: Historic Resources of West Helena, Arkansas, 1900-1945

Gemmill-Faust House
Name of Property

Phillips County, AR
County and State

=====
4. State/Federal Agency Certification
=====

As the designated authority under the National Historic Preservation Act of 1986, as amended, I hereby certify that this X nomination _____ request for determination of eligibility meets the documentation standards for registering properties in the National Register of Historic Places and meets the procedural and professional requirements set forth in 36 CFR Part 60. In my opinion, the property X meets _____ does not meet the National Register Criteria. _____ See continuation sheet

Cathryn A. Slater
Signature of certifying official

9-4-96
Date

Arkansas Historic Preservation Program
State or Federal agency and bureau

In my opinion, the property X meets _____ does not meet the National Register criteria. _____ See continuation sheet.

Signature of commenting or other official

Date

State or Federal agency and bureau

=====
5. National Park Service Certification
=====

I, hereby certify that this property is:

- | | | |
|---|-------|-------|
| <u> </u> entered in the National Register | _____ | _____ |
| <u> </u> <u> </u> See continuation sheet. | _____ | _____ |
| <u> </u> determined eligible for the National Register | _____ | _____ |
| <u> </u> <u> </u> See continuation sheet. | _____ | _____ |
| <u> </u> determined not eligible for the National Register | _____ | _____ |
| <u> </u> removed from the National Register | _____ | _____ |
| <u> </u> other (explain): _____ | _____ | _____ |

Signature of Keeper

Date of Action

Gemmill-Faust House
Name of Property

Phillips County, AR
County and State

=====

6. Function or Use

=====

Historic: DOMESTIC Sub: Single dwelling

Current: DOMESTIC Sub: Single dwelling

=====

7. Description

=====

Architectural Classification:

Prairie

Other Description: N/A

Materials: foundation Brick/Stucco roof Asphalt
 walls Brick other N/A

- Describe present and historic physical appearance. See continuation sheet.

Description

The Gemmill-Faust House (at 321 St. Andrew's Terrace) is a two-and-one-half story, wood frame and brick masonry residence designed in the Prairie style. Dominated by the broad, spreading eaves of the main hipped roof and surmounting hipped dormer, the house includes such other characteristic features as the light colored brick, the straight, square brick columns that support the flat roof front porch, the flat roof on both the northern porte cochere and the southern sun room, the ribbon window configurations on virtually all elevations, and the multi-pane clear glass windows throughout. An assortment of window and door types are also employed. Two brick chimneys -- one adjacent to the northern wall and the other rising near the intersection of the northern and western slopes of the hipped roof -- vent the interior. The asphalt shingle roof and brick walls rest upon a continuous brick foundation, covered with stucco to resemble stone.

Also included in the nomination is an original, single-story, hipped roof brick garage building located directly to the west or rear of the main house. It contains a single brick chimney rising from the center of the structure. It is contributing.

Gemmill-Faust House
Name of Property

Phillips County, AR
County and State

=====
8. Statement of Significance
=====

Certifying official has considered the significance of this property in relation to other properties: Locally.

Applicable National Register Criteria: C

Criteria Considerations (Exceptions): N/A

Areas of Significance: ARCHITECTURE

Period(s) of Significance: c. 1920

Significant Dates: c. 1920

Significant Person(s): N/A

Cultural Affiliation: N/A

Architect/Builder: Unknown

State significance of property, and justify criteria, criteria considerations, and areas and periods of significance noted above.
 See continuation sheet.

Significance Criterion C, local significance

The Gemmill-Faust House (at 321 St. Andrew's Terrace) is locally significant under Criterion C by virtue of its status as the best example of a pure Prairie style house in West Helena. Constructed just south of the ninety-degree turn at the eastern end of Plaza Avenue in one of the residential areas of the city developed slightly later than those sections immediately to the west, it is associated with the historic context *Historic Resources of West Helena, Arkansas, 1900-1945* as one of the few surviving historic homes with any degree of integrity, and as the best known extant example of this popular national architectural style.

=====
9. Major Bibliographical References
=====

See "Historic Resources of West Helena, Arkansas, 1900-1945," Section H.

___ See continuation sheet.

Previous documentation on file (NPS):

- preliminary determination of individual listing (36 CFR 67) has been requested.
- previously listed in the National Register
- previously determined eligible by the National Register
- designated a National Historic Landmark
- recorded by Historic American Buildings Survey # _____
- recorded by Historic American Engineering Record # _____

Primary Location of Additional Data:

- X State historic preservation office
- Other state agency
- Federal agency
- Local government
- University
- Other -- Specify Repository: _____

=====
10. Geographical Data
=====

Acreage of Property: Approximately 1.5

UTM References: Zone Easting Northing Zone Easting Northing
A 15 717180 3824245 B 15
C 15 D 15

___ See continuation sheet.

Verbal Boundary Description: ___ See continuation sheet.

Beginning at a point formed by the intersection of the western edge of St. Andrew's Terrace with a perpendicular line running parallel with the building's southern elevation and located approximately 50 feet to the south thereof, proceed westerly along said line for approximately 300 feet; thence proceed northerly along a perpendicular line for approximately 200 feet; thence proceed easterly along a perpendicular line for approximately 300 feet to its intersection with the western edge of St. Andrew's Terrace; thence proceed southerly along said edge to the point of beginning.

Gemmill-Faust House
Name of Property

Phillips County, AR
County and State

Boundary Justification: See continuation sheet.

This boundary includes all the property historically associated with this resource that retains its integrity.

=====

11. Form Prepared By

=====

Name/Title: Ken Story, National Register/Survey Coordinator

Organization: Arkansas Historic Preservation Program Date: 09/03/96

Street & Number: 323 Center Street, Suite 1500 Telephone: (501) 324-9880

City or Town: Little Rock State: AR Zip: 72201



HISTORICAL RESOURCES
OF HELENA,
ARIZONA
WEST HELENA,
PHILLIPS CO., AR

PH0270
15/716530/
3825000

PH0271
15/715100/
3824800

PH0272
15/717180/
3824245

PH0273
15/717180/
3824320

PH0274
15/717180/
3824465

PH0275
3824760
15/717140/

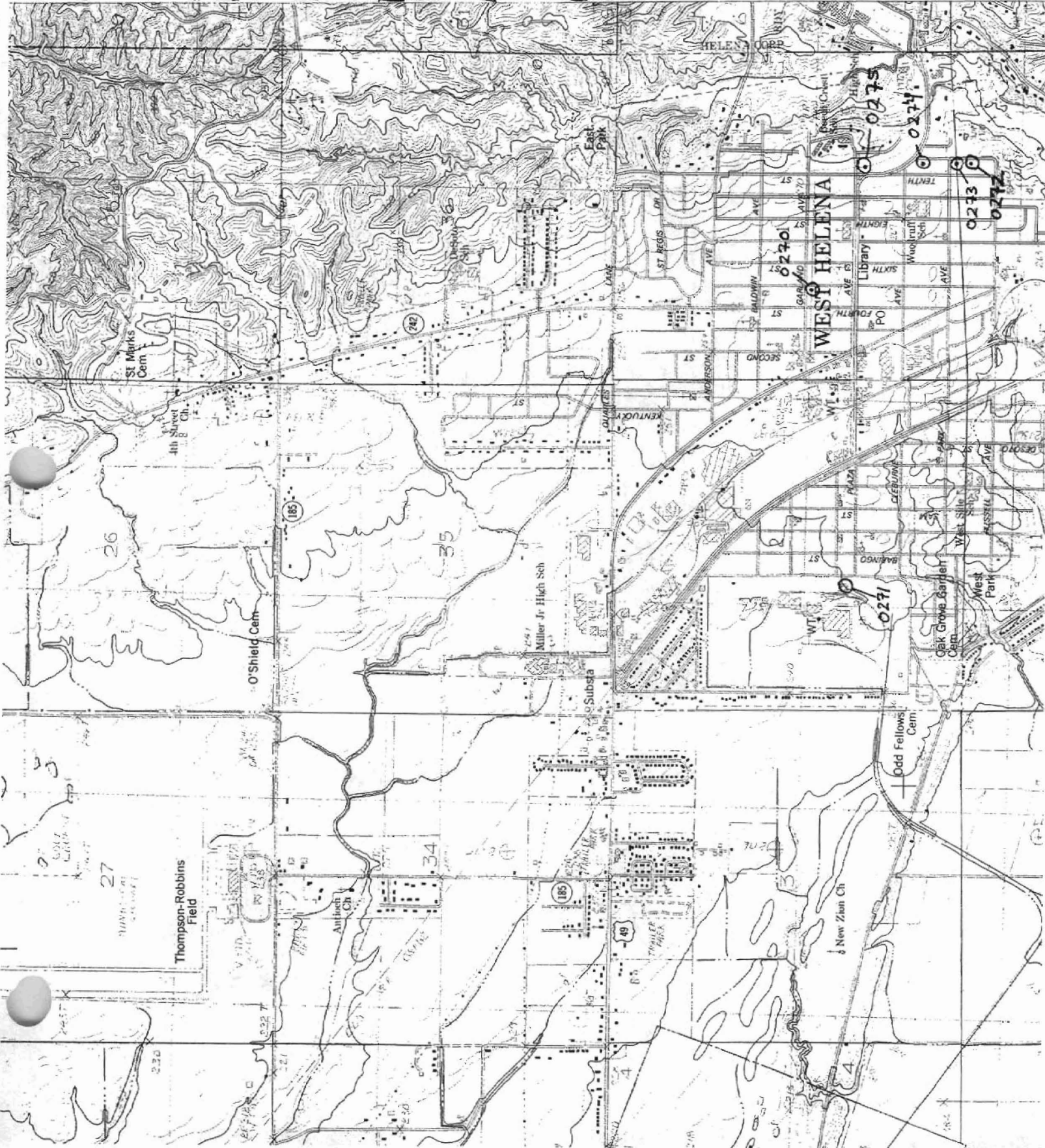

3925

32' 30"

3924