

52-01-C040-72

NR 11-9-72

**NATIONAL REGISTER OF HISTORIC PLACES  
INVENTORY - NOMINATION FORM**

(Type all entries - complete applicable sections)

COUNTY:	Ouachita
FOR NPS USE ONLY	
ENTRY NUMBER	DATE

**1. NAME**

COMMON:  
Tate's Barn

AND/OR HISTORIC:

**2. LOCATION**

STREET AND NUMBER:  
902 Tate Street

CITY OR TOWN:  
Camden

STATE: Arkansas CODE: 05 COUNTY: Ouachita CODE: 039

**3. CLASSIFICATION**

CATEGORY (Check One)	OWNERSHIP	STATUS	ACCESSIBLE TO THE PUBLIC
<input type="checkbox"/> District <input type="checkbox"/> Site <input type="checkbox"/> Object <input checked="" type="checkbox"/> Building <input type="checkbox"/> Structure	<input type="checkbox"/> Public <input checked="" type="checkbox"/> Private <input type="checkbox"/> Both	<input checked="" type="checkbox"/> Occupied <input type="checkbox"/> Unoccupied <input type="checkbox"/> Preservation work in progress	Yes: <input checked="" type="checkbox"/> Restricted <input type="checkbox"/> Unrestricted <input type="checkbox"/> No

PRESENT USE (Check One or More as Appropriate)

<input checked="" type="checkbox"/> Agricultural	<input type="checkbox"/> Government	<input type="checkbox"/> Park	<input type="checkbox"/> Transportation	<input type="checkbox"/> Comments
<input type="checkbox"/> Commercial	<input type="checkbox"/> Industrial	<input type="checkbox"/> Private Residence	<input type="checkbox"/> Other (Specify)	_____
<input type="checkbox"/> Educational	<input type="checkbox"/> Military	<input type="checkbox"/> Religious	_____	_____
<input type="checkbox"/> Entertainment	<input type="checkbox"/> Museum	<input type="checkbox"/> Scientific	_____	_____

**4. OWNER OF PROPERTY**

OWNER'S NAME:  
Mrs. Walter F. Tate

STREET AND NUMBER:  
902 Tate Street

CITY OR TOWN: Camden STATE: Arkansas CODE: 05

**5. LOCATION OF LEGAL DESCRIPTION**

COURTHOUSE, REGISTRY OF DEEDS, ETC.:  
Ouachita County Courthouse

STREET AND NUMBER:

CITY OR TOWN: Camden STATE: Arkansas CODE: 05

**6. REPRESENTATION IN EXISTING SURVEYS**

TITLE OF SURVEY:

DATE OF SURVEY:  Federal  State  County  Local

DEPOSITORY FOR SURVEY RECORDS:

STREET AND NUMBER:

CITY OR TOWN: STATE: CODE:

SEE INSTRUCTIONS

STATE: COUNTY: ENTRY NUMBER: DATE: FOR NPS USE ONLY

## DESCRIPTION

CONDITION	(Check One)					
	<input type="checkbox"/> Excellent	<input checked="" type="checkbox"/> Good	<input type="checkbox"/> Fair	<input type="checkbox"/> Deteriorated	<input type="checkbox"/> Ruins	<input type="checkbox"/> Unexposed
	(Check One)			(Check One)		
	<input type="checkbox"/> Altered	<input checked="" type="checkbox"/> Unaltered	<input type="checkbox"/> Moved	<input checked="" type="checkbox"/> Original Site		

DESCRIBE THE PRESENT AND ORIGINAL (If known) PHYSICAL APPEARANCE

The barn at the Tate estate is a well constructed, multi-level farm utility structure.

The main portion of the structure is thirty-seven feet wide and fifty feet long, consisting of a potato cellar, two corn storage rooms, an equipment storage room and a two level hayloft. There are two sheds twelve feet wide and fifty feet long, the one on the north for implement storage and one on the south for horse stalls.

The roof of the Tate Barn is covered with hand-cut cypress shakes while the walls are covered with clapboard siding. The roof of the north shed projects from the north wall of the barn and its north edge is supported by six four-inch by six-inch posts. The posts are supported by solid isosceles shaped concrete blocks at their base, and braced at the top by two by four timbers that taper inward about two feet from the edge of the roof to the posts. The roof has an eight foot overhang on the west side and a two foot overhang on the east side.

The south shed has solid walls on its north, east and west sides, while the south side is mostly open with boards nailed horizontally across it much in the same manner as a wooden fence, with approximately a one foot opening between each board. The roof is covered with cedar shakes and is similar to that of the north shed.

The haylofts are loaded through two large horizontally sliding doors on the front (west) and rear (east) facades. A rail is suspended from and parallel to the ridge supporting a trolley and hook assembly for handling large loads.

The west elevation of the main section of the barn has five openings. The three lower doorways are entrances to different levels of the barn. Located in between and just above the south and central doorways is a sliding door which opens into a hayloft area. Another small swinging door is located above and north of the sliding door. The east elevation has four openings. The south end of this elevation has a ground level doorway. A sliding door is located above and north of the

SEE INSTRUCTIONS

8. SIGNIFICANCE

PERIOD (Check One or More as Appropriate)

- Pre-Columbian |  16th Century |  18th Century |  20th Century  
 15th Century |  17th Century |  19th Century

SPECIFIC DATE(S) (If Applicable and Known)

AREAS OF SIGNIFICANCE (Check One or More as Appropriate)

- |  |   |  |  |
|--|---|--|--|
| <input type="checkbox"/> Aboriginal              | <input type="checkbox"/> Education              | <input type="checkbox"/> Political           | <input type="checkbox"/> Urban Planning  |
| <input type="checkbox"/> Prehistoric             | <input type="checkbox"/> Engineering            | <input type="checkbox"/> Religion/Philosophy | <input type="checkbox"/> Other (Specify) |
| <input type="checkbox"/> Historic                | <input type="checkbox"/> Industry               |  | _____                                    |
| <input checked="" type="checkbox"/> Agriculture  | <input type="checkbox"/> Invention              | <input type="checkbox"/> Science             | _____                                    |
| <input checked="" type="checkbox"/> Architecture | <input type="checkbox"/> Landscape Architecture | <input type="checkbox"/> Sculpture           | _____                                    |
| <input type="checkbox"/> Art                     | <input type="checkbox"/> Literature             | <input type="checkbox"/> Social/Humanitarian | _____                                    |
| <input type="checkbox"/> Commerce                | <input type="checkbox"/> Military               | <input type="checkbox"/> Theater             | _____                                    |
| <input type="checkbox"/> Communications          | <input type="checkbox"/> Music                  | <input type="checkbox"/> Transportation      | _____                                    |
| <input type="checkbox"/> Conservation            |   |  | _____                                    |

STATEMENT OF SIGNIFICANCE

The Tates were among the earliest settlers of Arkansas and were the first settlers of Ouachita County. In 1816 Captain Richard Tate, a veteran of the War of 1812, left North Carolina with Abe, his slave, seeking gold. After a short and unprofitable stay in Oklahoma, the Captain returned to Tennessee where some of his relatives lived.

In the fall 1818, however, he again headed west to Arkansas. On May 5, 1819, the boat became stranded on the Ouachita River, and the two men, master and slave, settled nearly on a spot thereafter known as Tate's Bluff. Ten years later, other Tates followed. Richard's nephews, John Tate, who brought his wife and four sons; and William H. Tate, along with his wife and brother-in-law. Also included in the group were Richard's niece and her husband, Mr. Dousak Gates, and a Mr. Harrison and a Mr. Watkins.

Members of the family were, thus, prominent in Ouachita County from its first settlement. Judge W. F. Tate although born in Dallas County, was a descendent of Captain Tate and returned to that area his forbears had settled. Judge Tate served as county judge, and secretary of the school board for many years in addition to other interests.

Consequently, the Tate property has considerable local historical significance. However, the principal importance of the Tate Barn arises from its being nothing more or less than a first-class barn. Its five levels and its roof of hand-cut cypress shingles make it fairly elaborate for a farm building. This and its unaltered

SEE INSTRUCTIONS

**NATIONAL REGISTER OF HISTORIC PLACES  
PROPERTY MAP FORM**

(Type all entries - attach to or enclose with map)

STATE Arkansas	
COUNTY Ouachita	
FOR NPS USE ONLY	
ENTRY NUMBER	DATE

SEE INSTRUCTIONS

<b>1. NAME</b>			
COMMON: Tate's Barn			
AND/OR HISTORIC:			
<b>2. LOCATION</b>			
STREET AND NUMBER: 902 Tate Street			
CITY OR TOWN: Camden			
STATE: Arkansas	CODE 05	COUNTY: Ouachita	CODE 039
<b>3. MAP REFERENCE</b>			
SOURCE: U.S.G.S. 7.5' Series Camden, Arkansas Quadrangle			
SCALE: 1:24,000			
DATE: 1951			
<b>4. REQUIREMENTS</b>			
TO BE INCLUDED ON ALL MAPS			
1. Property boundaries where required.			
2. North arrow.			
3. Latitude and longitude reference.			

**NATIONAL REGISTER OF HISTORIC PLACES  
PROPERTY PHOTOGRAPH FORM**

(Type all entries - attach to or enclose with photograph)

STATE Arkansas	
COUNTY Ouachita	
FOR NPS USE ONLY	
ENTRY NUMBER	DATE

SEE INSTRUCTIONS

<b>1. NAME</b>			
COMMON: Tate's Barn			
AND/OR HISTORIC:			
<b>2. LOCATION</b>			
STREET AND NUMBER: 902 Tate Street			
CITY OR TOWN: Camden			
STATE: Arkansas	CODE 05	COUNTY: Ouachita	CODE 039
<b>3. PHOTO REFERENCE</b>			
PHOTO CREDIT: Staff, Arkansas Historic Preservation Program			
DATE OF PHOTO: 1971			
NEGATIVE FILED AT: Arkansas History Commission			
<b>4. IDENTIFICATION</b>			
DESCRIBE VIEW, DIRECTION, ETC			
View from northeast.			

NATIONAL REGISTER OF HISTORIC PLACES  
INVENTORY - NOMINATION FORM

(Continuation Sheet)

STATE	
Arkansas	
COUNTY	
Ouachita	
FOR NPS USE ONLY	
ENTRY NUMBER	DATE

(Number all entries)

7. Description

ground level doorway and two small hinged openings are located in a horizontal line north of the sliding door.

The barn interior is a complex plan that has a total of five levels. The lowest level is the potato cellar, which is located in the northwest corner of the building. The entrance to the cellar is the north door of the west side of the barn. The center door of the main section of the barn leads to a hallway, which is the access to the other three levels. The hallway runs east and west with stairs on the west end at the entrance that ascend to the third level. The rooms on the third level are made accessible by a hallway that runs north and south and intersects the east-west hall forming a T-shape on the north side of the east-west wall. This level consists of two rooms located on either side of the north-south hall. On the south side of the intersection of the hall are a door and a stairway that leads to the east room of the second level. The west room of the second level is directly west of the east room and in the southwest corner of the barn.

The fourth and fifth levels are storage areas for hay and would be considered the barn loft. The access to the fourth level, which is one large room, is the stairway on the east end of the east-west hall. A small section of stairs on the north-central side of the fourth level leads to the fifth level, which is also one large open room used as a hayloft. There is a large sliding door on both the east and west sides of the fourth level with a small opening on the west end of the fifth level.

The barn is built of cypress timbers. The structural frame is a braced post and lintel system. The columns and beams are four by six inches in sectional dimension with two by six

NATIONAL REGISTER OF HISTORIC PLACES  
INVENTORY - NOMINATION FORM

(Continuation Sheet)

STATE	
Arkansas	
COUNTY	
Ouachita	
FOR NPS USE ONLY	
ENTRY NUMBER	DATE

(Number all entries)

7. Description

joists and one by three stripping under the cypress shingles.

Because of the excellent weathering quality of its cypress timbers and the outstanding craftsmanship employed in its construction, Tate's Barn is in good physical condition.

NATIONAL REGISTER OF HISTORIC PLACES  
INVENTORY - NOMINATION FORM

(Continuation Sheet)

STATE	
Arkansas	
COUNTY	
Ouachita	
FOR NPS USE ONLY	
ENTRY NUMBER	DATE

(Number all entries)

8. Significance

state make it almost unique.

The structure was probably built during the 1880's, although the exact date of construction is uncertain. It is an excellent example and a well-preserved symbol of a life style that is rapidly disappearing from the Mid-South. When it was built the state was almost entirely rural, Little Rock and Fort Smith were only small towns; Fayetteville and Hot Springs, only large villages. No famous general ever quartered his horses at the Barn; no notorious desperadoes ever "hid out" from the law in the place; yet it remains a simple and rather dignified relic of the past.

9. MAJOR BIBLIOGRAPHICAL REFERENCES

Camden, Arkansas. Personal interview with Mrs. Walter F. Tate. June, 1971.

10. GEOGRAPHICAL DATA

LATITUDE AND LONGITUDE COORDINATES DEFINING A RECTANGLE LOCATING THE PROPERTY			O R	LATITUDE AND LONGITUDE COORDINATES DEFINING THE CENTER POINT OF A PROPERTY OF LESS THAN TEN ACRES		
CORNER	LATITUDE	LONGITUDE		LATITUDE	LONGITUDE	
	Degrees Minutes Seconds	Degrees Minutes Seconds		Degrees Minutes Seconds	Degrees Minutes Seconds	
NW	0	0		33° 32' 30"	92° 50' 41"	
NE	0	0				
SE	0	0				
SW	0	0				

APPROXIMATE ACREAGE OF NOMINATED PROPERTY:

LIST ALL STATES AND COUNTIES FOR PROPERTIES OVERLAPPING STATE OR COUNTY BOUNDARIES

STATE:	CODE	COUNTY	CODE
STATE:	CODE	COUNTY:	CODE
STATE:	CODE	COUNTY:	CODE
STATE:	CODE	COUNTY:	CODE

11. FORM PREPARED BY

NAME AND TITLE:  
Staff

ORGANIZATION: Arkansas Historic Preservation Program      DATE: 1971

STREET AND NUMBER:  
1023 West Third Street

CITY OR TOWN: Little Rock      STATE: Arkansas      CODE: 05

12. STATE LIAISON OFFICER CERTIFICATION

As the designated State Liaison Officer for the National Historic Preservation Act of 1966 (Public Law 89-665), I hereby nominate this property for inclusion in the National Register and certify that it has been evaluated according to the criteria and procedures set forth by the National Park Service. The recommended level of significance of this nomination is:

National  State  Local

Name \_\_\_\_\_

Title State Liaison Officer

Date \_\_\_\_\_

NATIONAL REGISTER VERIFICATION

I hereby certify that this property is included in the National Register.

\_\_\_\_\_  
Chief, Office of Archeology and Historic Preservation

Date \_\_\_\_\_

ATTEST:

\_\_\_\_\_  
Keeper of The National Register

Date \_\_\_\_\_

SEE INSTRUCTIONS



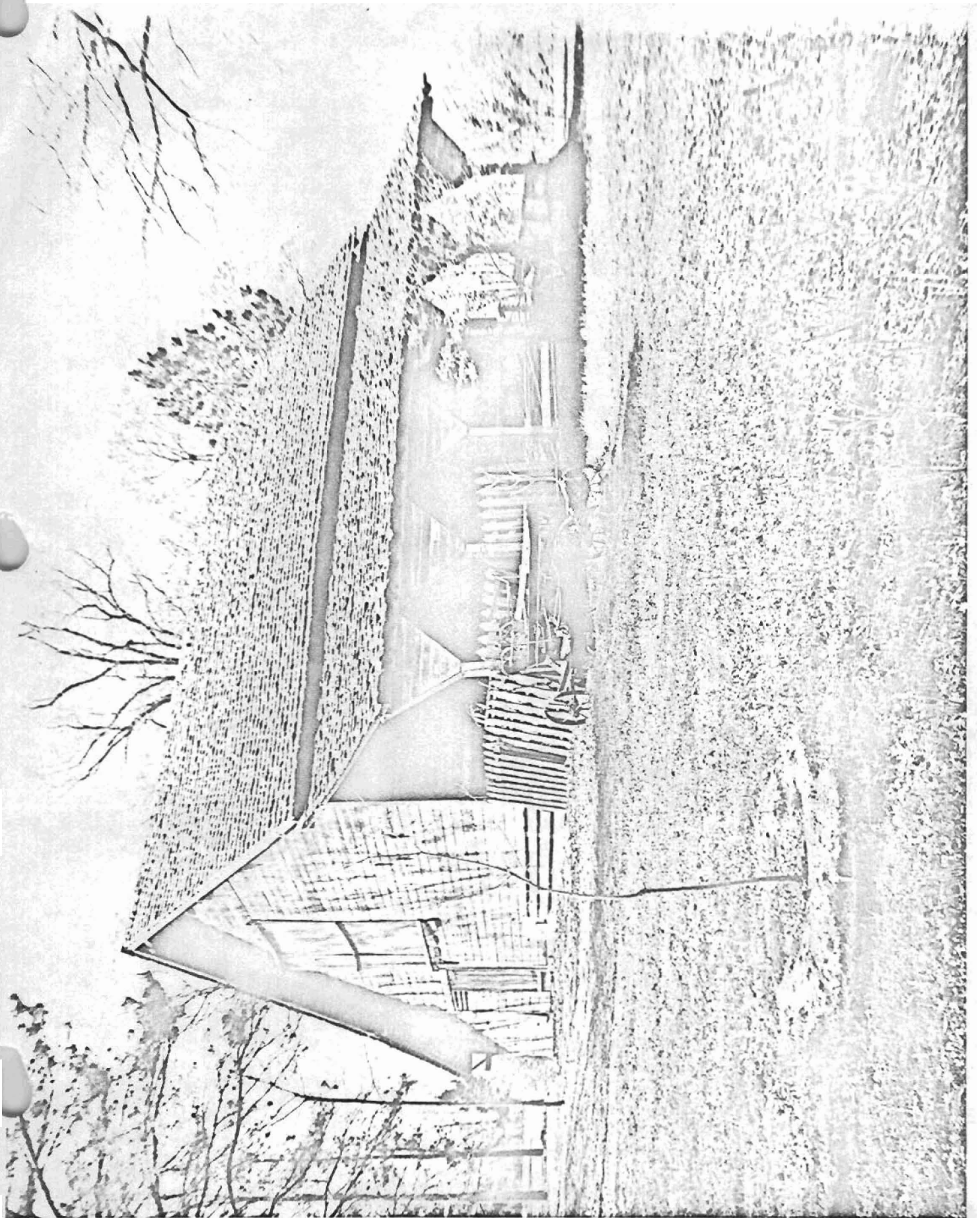

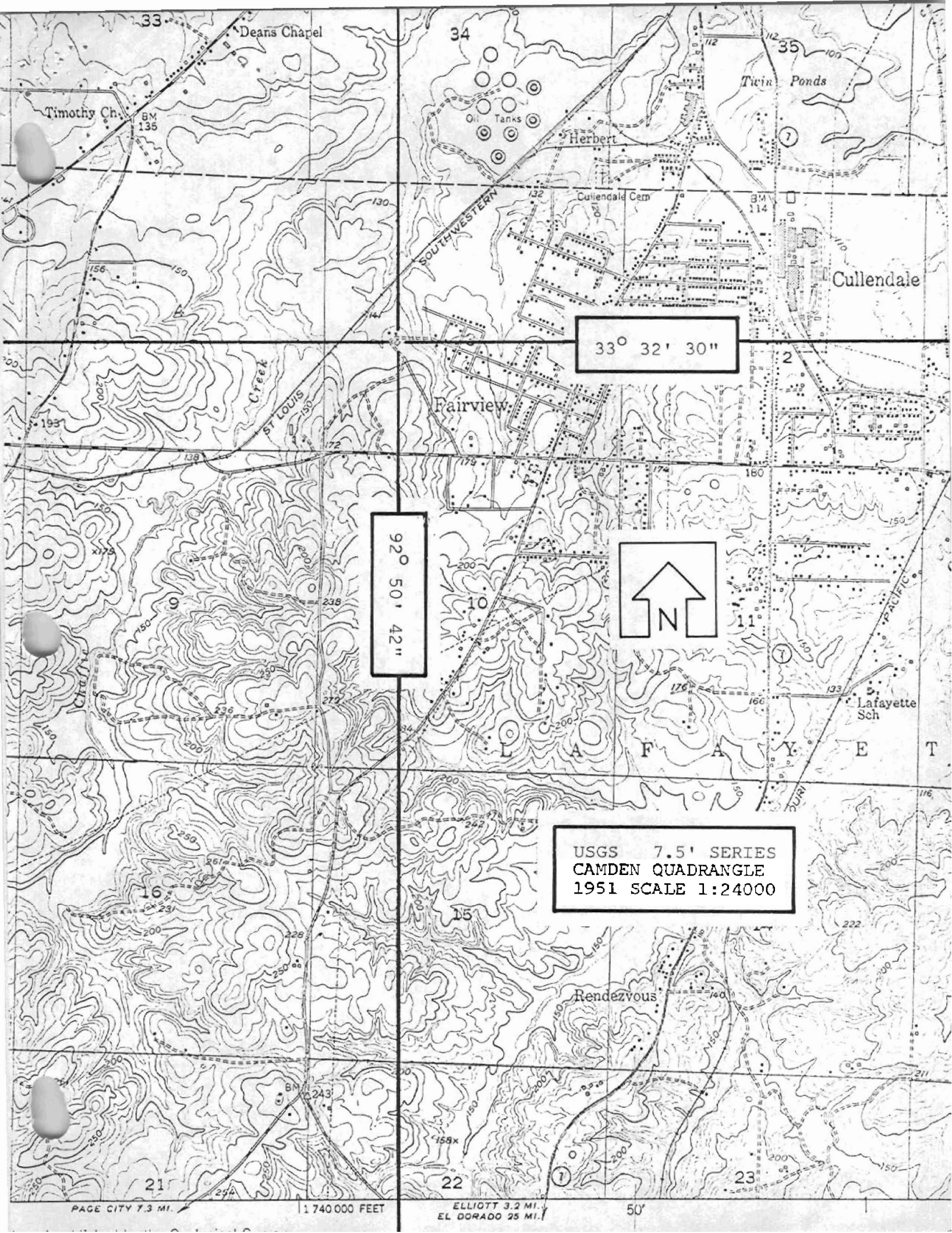

33

Deans Chapel

34

Twin Ponds

Timothy Ch.

BM 135

Herbert

7

SOUTHWESTERN

Cullendale Cem

Cullendale

33° 32' 30"

Fairview

92° 50' 42"

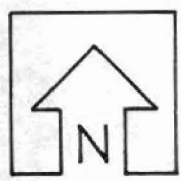

USGS 7.5' SERIES  
CAMDEN QUADRANGLE  
1951 SCALE 1:24000

Lafayette Sch

L A F A Y E T

Rendezvous

21

22

23

PAGE CITY 7.3 MI.

1:740 000 FEET

ELLIOTT 3.2 MI.  
EL DORADO 25 MI.

50'