

United States Department of the Interior
National Park Service

NATIONAL REGISTER OF HISTORIC PLACES
REGISTRATION FORM

=====

1. Name of Property

=====

historic name: Old Walnut Ridge Post Office

other name/site number: N/A

=====

2. Location

=====

street & number: 225 W. Main

not for publication: N/A

city/town: Walnut Ridge

vicinity: N/A

state: AR

county: Lawrence

code: AR 075

zip code: 72476

=====

3. Classification

=====

Ownership of Property: Private

Category of Property: Building

Number of Resources within Property:

Contributing	Noncontributing	
<u>1</u>	_____	buildings
_____	_____	sites
_____	_____	structures
_____	_____	objects
<u>1</u>	<u>0</u>	Total

Number of contributing resources previously listed in the National Register: N/A

Name of related multiple property listing: N/A

=====
4. State/Federal Agency Certification
=====

As the designated authority under the National Historic Preservation Act of 1986, as amended, I hereby certify that this X nomination _____ request for determination of eligibility meets the documentation standards for registering properties in the National Register of Historic Places and meets the procedural and professional requirements set forth in 36 CFR Part 60. In my opinion, the property X meets _____ does not meet the National Register Criteria. _____ See continuation sheet

Cathryn A. Slater _____ 7-6-94
Signature of certifying official Date

Arkansas Historic Preservation Program
State or Federal agency and bureau

In my opinion, the property _____ meets _____ does not meet the National Register criteria. _____ See continuation sheet.

Signature of commenting or other official Date

State or Federal agency and bureau

=====
5. National Park Service Certification
=====

I, hereby certify that this property is:

____ entered in the National Register _____
_____ See continuation sheet.
____ determined eligible for the _____
National Register _____
_____ See continuation sheet.
____ determined not eligible for the _____
National Register _____
____ removed from the National Register _____
____ other (explain): _____

Signature of Keeper Date
of Action

=====
6. Function or Use
=====

Historic: Government _____ Sub: post office _____

Current : Industry _____ Sub: communications facility _____

=====
7. Description
=====

Architectural Classification:

Colonial Revival

Other Description: N/A

Materials: foundation Concrete roof Asphalt
walls Brick other Wood, Stucco

Describe present and historic physical appearance. X See continuation sheet.

=====
8. Statement of Significance
=====

Certifying official has considered the significance of this property in relation to other properties: local.

Applicable National Register Criteria: C

Criteria Considerations (Exceptions): N/A

Areas of Significance: Architecture

Period(s) of Significance: 1935

Significant Dates: 1935

Significant Person(s): N/A

Cultural Affiliation: N/A

Architect/Builder: Simon, Louis A., Architect
Melick, Neal A., Supervising Engineer

State significance of property, and justify criteria, criteria considerations, and areas and periods of significance noted above.
X See continuation sheet.

=====
9. Major Bibliographical References
=====

See continuation sheet.

Previous documentation on file (NPS):

- preliminary determination of individual listing (36 CFR 67) has been requested.
- previously listed in the National Register
- previously determined eligible by the National Register
- designated a National Historic Landmark
- recorded by Historic American Buildings Survey #
- recorded by Historic American Engineering Record #

Primary Location of Additional Data:

- X State historic preservation office
- Other state agency
- Federal agency
- Local government
- University
- Other -- Specify Repository:

=====
10. Geographical Data
=====

Acreage of Property: Less than one

UTM References: Zone Easting Northing Zone Easting Northing

Table with 4 columns: A, B, C, D. Row 1: 15, 683950, 3993380, B. Row 2: C, D.

See continuation sheet.

Verbal Boundary Description: See continuation sheet.

W 1/2 Lot 5 and all of Lot 6, Block 11, Original Town of Walnut Ridge.

Boundary Justification: See continuation sheet.

This boundary includes all of the property historically associated with th resource.

=====

11. Form Prepared By

=====

Name/Title: Patrick Zollner, National Register Historian

Organization: Arkansas Historic Preservation Program Date: 03/25/94

Street & Number: 323 Center, 1600 Tower Bldg. Telephone: (501) 324-9880

City or Town: Little Rock State: AR ZIP: 72201

United States Department of the Interior
National Park Service

National Register of Historic Places Continuation Sheet

Section number 7 Page 1

Summary

Built in 1935, the Old Walnut Ridge Post Office is a one-and-a-half story, brick-constructed government building with a full basement. The Colonial Revival-style structure is virtually unaltered and features all of the original Post Office interior detail. Located at the southern corner of West Main and SW Third Streets, the Old Walnut Ridge Post Office now serves as the offices and press for *The Times Dispatch* newspaper.

Elaboration

Built in 1935 at the southern corner of West Main Street and SW Third Streets, the Old Walnut Ridge Post Office is a one-and-a-half story, brick-constructed government building with a full basement that is partially above ground. Designed by Treasury Department architect, Louis A. Simon, the T-shaped building reflects the familiar Colonial Revival style that was utilized by the Post Office during that era. The full basement rests upon a continuous concrete foundation, and the side-gable roof is covered with composition shingles. The majority of the building to the rear, however, is covered by a flat roof behind a concrete-capped brick parapet. There is one exterior brick chimney on the southeastern elevation.

The front, or northeastern, elevation features a central double-leaf entrance that is flanked by two fluted Ionic pilasters and crowned with a broken triangular pediment. Decorative wood panels are found above the doors where the transom would be normally and between the top of the pilasters and the pediment. The pediment is adorned by a dentil course both underneath and within the pediment and has a decorative urn at the apex. Four wood-framed, nine-over-nine double-hung windows fenestrate this elevation and are symmetrically arranged with two on each side of the entrance. Each window is protected by functional white-painted wood shutters. Above the two windows near the entrance, there are two concrete panels inscribed respectively with "United States Post Office" and "Walnut Ridge, Arkansas." The concrete eave has no appreciable overhang, but is ornamented with a row of modillions beneath the cornice and a wide frieze. The frieze now bears the name "The Times Dispatch" in detachable black letters. A concrete watertable separates the basement level, which is fenestrated by four six-over-six double-hung windows placed underneath their first-story counterparts.

The gable-end bay on the northwestern elevation contains only a single nine-over-nine window in its center; however, this window is boldly ornamented with a white-painted, wooden fanlight that is surrounded by a semi-circular band of beige stucco that is the width of the white shutters. The stucco band is further outlined with brick, two base stones and a keystone. A stucco band that is the width of the window and shutters is located underneath the window and

United States Department of the Interior
National Park ServiceNational Register of Historic Places
Continuation SheetSection number 7 Page 2

is adorned with decorative wrought iron that may have been added later. Otherwise, the actual gable end has cornice and frieze returns, while the basement level has a central six-over-six window and a single-leaf entrance to the south. The door is accessed by concrete steps descending parallel to the wall.

Two small four-over-four double-hung windows and two nine-over-nine windows that are larger than the gable-end bay window fenestrate the center section of the northwestern elevation. Underneath, there are two six-over-six windows to illuminate the basement on this elevation. The rear, or southwestern, elevation of this center section (which abuts the rear "T" projection) also contains a large nine-over-nine double-hung window. The northwestern elevation of the "T" projection consists of a small four-over-four window, a single-leaf metal door, and a six-over-six window for a second story placed just below the cornice of the frieze (the brick parapet extends higher on the "T" section than the center section). Three metal roll-up doors that are raised for loading ease characterize the rear, or southwestern, elevation of the "T" section. A flat metal roof supported by metal rods from above extends above the doors. Again, the frieze band is punctuated by fenestration in the form of three pairs of small one-over-one double-hung windows.

The first-story of the southeastern elevation of the "T" section is not fenestrated, although it appears that a window has been filled at some point. The upper story is lighted on the elevation by a six-over-six double-hung window below the cornice. The southwestern elevation of the center section contains a central nine-over-nine double-hung window and a single-leaf entrance in the basement (accessed by steps descending parallel to the "T" section). Two nine-over-nine double-hung windows flank the large chimney on the southeastern elevation of the center section. The gable-end bay on this elevation is identical to that of the northwestern elevation with the exception that there are currently no wood shutters, and the stucco band surrounding the window is revealed instead.

Remarkably, the interior is virtually unaltered since construction and features all of the original post office fixtures except the actual post office boxes, which were removed to the new postal facility. The lobby is characterized by marble wainscoting and the dark-stained, wood and glass entry room with its single-leaf doors to each side. The original teller windows remain as does the cast-iron vault door.

In 1977, the Post Office moved into a larger facility, and *The Times Dispatch* newspaper purchased the building for their offices and printing press. No major exterior or interior changes were required for this new usage. There are no outbuildings associated with this property.

**United States Department of the Interior
National Park Service**

**National Register of Historic Places
Continuation Sheet**

Section number 8 Page 1

Summary

The Old Walnut Ridge Post Office is being nominated under Criterion C with local significance as the best example in Walnut Ridge of a Colonial Revival-style government building.

Elaboration

In 1867, Colonel W. M. Ponder moved from Missouri and settled near the site of the present town of Walnut Ridge and engaged in farming and sawmilling. A year later, a post office was established with Ponder as the postmaster and named Walnut Ridge, after the stand of walnut trees which grew on the slightly rolling hills. In 1873, the St. Louis, Iron Mountain & Southern Railroad came through the area, and Ponder donated and cleared the land for the depot. After the new town was laid out by the chief engineer for the railroad, Ponder and the post office moved from "Old Walnut Ridge" to the new town.

Walnut Ridge was incorporated on August 31, 1880, and generally prospered. By 1920, the population was 2,226, and the town consisted of two banks, a cotton compress, a cotton seed oil mill, two newspapers, sawmills, a hub and spoke factory, an ice factory, churches, modern public schools, and an opera house.

In 1935, a new post office building was constructed upon an order issued by Postmaster General James A. Farley. The new Colonial Revival-style building designed by the Treasury Department architect, Louis A. Simon, served as the post office until 1977, when a new facility was constructed. The Old Post Office Building was sold to *The Times Dispatch* newspaper. Incredibly, neither the exterior nor the interior of the building required any modifications for its new role of producing a newspaper.

The Old Walnut Ridge Post Office Building is being nominated under Criterion C with local significance by virtue of its remarkable integrity and the fact that it is the best example of a Colonial Revival-style government building in Walnut Ridge and all of Lawrence County.

United States Department of the Interior
National Park Service

National Register of Historic Places Continuation Sheet

Section number 9 Page 1

Bibliography

Herndon, Dallas T. *Annals of Arkansas*. The Historical Record Association: Little Rock, 1947.
Vol. 1.

McLeod, Walter E. *Centennial Memorial History of Lawrence County*. Russellville, Arkansas:
Russellville Printing Co., 1936 (reprinted by the Lawrence County Historical Society
1980, 1985).

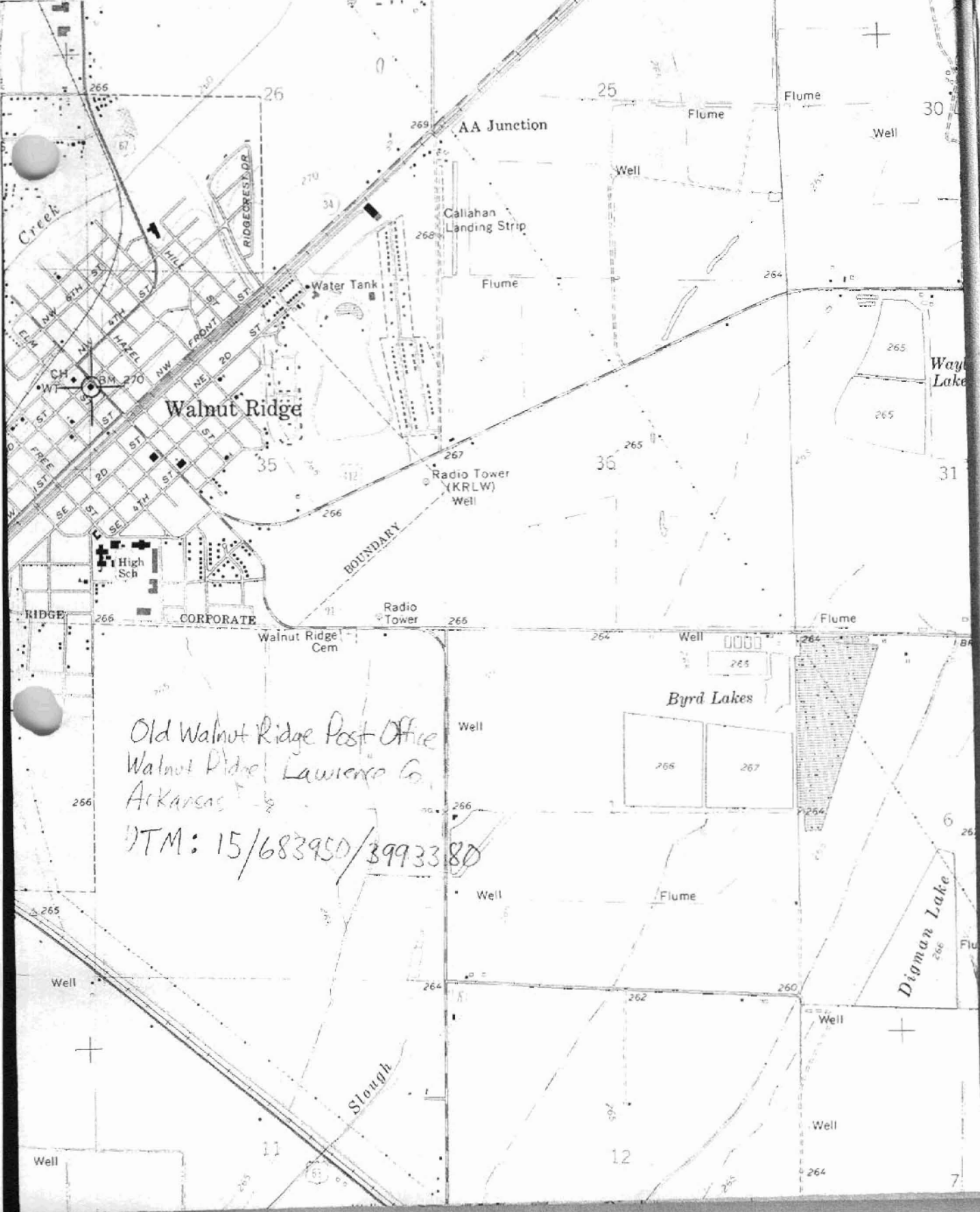

Old Walnut Ridge Post Office
Walnut Ridge, Lawrence Co,
Arkansas

DTM: 15/683950/3993380

