

NRLISTED 09/10/92

United States Department of the Interior
National Park Service

NATIONAL REGISTER OF HISTORIC PLACES
REGISTRATION FORM

=====

1. Name of Property

=====

historic name: Clarksville High School Building No. 1

other name/site number: JO0065

=====

2. Location

=====

street & number: Main Street

not for publication: N/A

city/town: Clarksville

vicinity: N/A

state: AR

county: Johnson

code: AR 071

zip code: 72830

=====

3. Classification

=====

Ownership of Property: Private

Category of Property: Building

Number of Resources within Property:

Contributing	Noncontributing	
<u>1</u>	_____	buildings
_____	_____	sites
_____	_____	structures
_____	_____	objects
<u>1</u>	<u>0</u>	Total

Number of contributing resources previously listed in the National Register: N/A

Name of related multiple property listing: Public Schools in the Arkansas Ozarks, 1920-1940

=====
4. State/Federal Agency Certification
=====

As the designated authority under the National Historic Preservation Act of 1986, as amended, I hereby certify that this X nomination _____ request for determination of eligibility meets the documentation standards for registering properties in the National Register of Historic Places and meets the procedural and professional requirements set forth in 36 CFR Part 60. In my opinion, the property X meets _____ does not meet the National Register Criteria. _____ See continuation sheet

Cathryn J. Byrd _____ 8-2-92
Signature of certifying official Date

Arkansas Historic Preservation Program
State or Federal agency and bureau

In my opinion, the property _____ meets _____ does not meet the National Register criteria. _____ See continuation sheet.

Signature of commenting or other official Date

State or Federal agency and bureau

=====
5. National Park Service Certification
=====

I, hereby certify that this property is:

- _____ entered in the National Register _____
_____ See continuation sheet.
- _____ determined eligible for the National Register _____
_____ See continuation sheet.
- _____ determined not eligible for the National Register _____
- _____ removed from the National Register _____
- _____ other (explain): _____

Signature of Keeper Date of Action

=====
6. Function or Use
=====

Historic: EDUCATION Sub: School

Current: VACANT/NOT IN USE Sub: N/A

=====

7. Description

=====

Architectural Classification:

Craftsman

Other Description: N/A

Materials: foundation Concrete roof Asphalt
walls Brick other Stucco
Wood half-timbering

Describe present and historic physical appearance. X See continuation sheet.

=====

8. Statement of Significance

=====

Certifying official has considered the significance of this property in relation to other properties: Locally.

Applicable National Register Criteria: A

Criteria Considerations (Exceptions): N/A

Areas of Significance: EDUCATION

Period(s) of Significance: 1936-1940

Significant Dates: N/A

Significant Person(s): N/A

Cultural Affiliation: N/A

Architect/Builder: Unknown

State significance of property, and justify criteria, criteria considerations, and areas and periods of significance noted above. X See continuation sheet.

=====

9. Major Bibliographical References

=====

See "Public Schools in the Arkansas Ozarks, 1920-1940" Multiple Property Form, Section H.

___ See continuation sheet.

Previous documentation on file (NPS):

- _ preliminary determination of individual listing (36 CFR 67) has been requested.
- _ previously listed in the National Register
- _ previously determined eligible by the National Register
- _ designated a National Historic Landmark
- _ recorded by Historic American Buildings Survey # _____
- _ recorded by Historic American Engineering Record # _____

Primary Location of Additional Data:

- X State historic preservation office
- _ Other state agency
- _ Federal agency
- _ Local government
- _ University
- _ Other -- Specify Repository: _____

=====

10. Geographical Data

=====

Acreage of Property: Less than one

UTM References: Zone Easting Northing Zone Easting Northing

A	<u>15</u>	<u>457150</u>	<u>3925220</u>	B	___	___	___
C	___	___	___	D	___	___	___

___ See continuation sheet.

Verbal Boundary Description: ___ See continuation sheet.

Beginning at a point formed by the intersection of a line running along the northern edge of Main Street with a perpendicular line running parallel with the building's eastern elevation and located approximately 25 feet to the east thereof, proceed northerly along said line for a distance of approximately 150 feet to its intersection with a perpendicular line running parallel to the building's northern elevation; thence proceed westerly along said line for a distance of approximately 150 feet to its intersection with a line running parallel to the building's western elevation; thence proceed southerly along said line for a distance of approximately 150 feet to its intersection with a perpendicular line running along the northern edge of Main Street; thence proceed easterly along said line for a distance of approximately 150 feet to the point of beginning.

Boundary Justification: ___ See continuation sheet.

This boundary includes both the historic resource and all the surrounding property known to have been historically associated therewith that retains its integrity.

=====

11. Form Prepared By

=====

Name/Title: Kenneth Story, National Register Coordinator

Organization: Arkansas Historic Preservation Program Date: July 16, 1992

Street & Number: 225 E. Markham, Suite 300 Telephone: (501) 324-9346

City or Town: Little Rock State: AR ZIP: 72201

**United States Department of the Interior
National Park Service**

**National Register of Historic Places
Continuation Sheet**

Section number 7 Page 1

Summary

The Clarksville High School Building No. 1 is a single story, wood frame classroom building that is faced with brick and stucco and designed in a relatively elaborate interpretation of the Craftsman style. Its fundamentally rectangular plan is augmented by the gable roof entrance porch at the building's eastern end and a smaller, shed roof porch on the northern elevation, but placed at the western end. The gable roof, along with the porch gable and the three gabled dormers are all covered with asphalt shingles, the walls are faced with brick, stucco and half-timbering, and a continuous cast concrete foundation supports the building.

Elaboration

The Clarksville High School Building No. 1 is a single story, wood frame classroom building that is faced with brick and stucco and designed in a relatively elaborate interpretation of the Craftsman style. Its fundamentally rectangular plan is augmented by the gable roof entrance porch at the building's eastern end and a smaller, shed roof porch on the northern elevation, but placed at the western end. A single, exterior brick chimney is placed against the eastern gable end, to the north of the peak. The gable roof, along with the porch gable and the three gabled dormers are all covered with asphalt shingles, the walls are faced with brick, stucco and half-timbering, and a continuous cast concrete foundation supports the building.

The southern or front elevation is composed of a projecting, pedimented entrance porch to the east and three window bays to the west. The entrance porch features decorative stucco and half-timbering in the pediment, which in turn is supported upon two, tall brick piers resting on a raised brick and concrete deck. The concrete steps at the front of the porch lead to a single-leaf entrance surrounded by full, ten-pane sidelights and a six-pane transom. The window bays to the west are each filled with three six-over-six wood sash windows. Directly above each of the window bays are three separate doghouse dormers, each decorated with exposed rafters and an arched, louvered vent. The northern elevation opposite is asymmetrically-organized, with a single-leaf entrance and projecting shed roof to the west of center, two individual windows in the center, and a single pair of windows to the east, finishing the elevation.

The western elevation also features stucco and half-timbering in the pediment of the gable end, and below, a single window to the north and two pairs of windows to the south. The eastern elevation opposite features the same pediment decoration and three separate windows below, placed asymmetrically in the wall around the off-center, stepped brick chimney.

**United States Department of the Interior
National Park Service**

National Register of Historic Places Continuation Sheet

Section number 7 Page 2

Significant exterior details include the stepped brick chimney, the exposed rafters around the cornice, the stucco and half-timbering in all the pediments, and the row of doghouse dormers that echo the pediment of the porch and thus lend the front facade such rhythm.

Clarksville High School Building No. 1 has suffered virtually no exterior alterations of any note. It is in good condition.

United States Department of the Interior
National Park Service

National Register of Historic Places Continuation Sheet

Section number 8 Page 1

Clarksville High School Building No. 1

Coal mining, natural gas production and the peach industry were staples of the Clarksville economy in the 1930's. Many local residents were employed in shipping the peach crop to distant cities to market; some drivers were known to sleep on the courthouse lawn so that they would be ready to leave at daybreak for the nearby orchards. Johnson County ranked third in the state in coal production during the 1930's, and natural gas resources began to be developed in 1929. Nevertheless, the poor economy reduced demand and lowered prices on much of the county's production, and the construction of the Clarksville High School Building in 1936 provided much needed employment for several local residents.¹

The Clarksville High School Building No. 1, constructed during the period covered by the historic context *The Evolution of the Public School System in the Arkansas Ozarks, 1920-1940*, is a representative example of a small, brick and stucco school building constructed for a small city school district. Its use during this period as a local school building clearly identifies it with this historic context and with this property type. It is significant locally under Criterion A through its direct associations with the history of the evolution of the public school system in the Ozark Mountain region of the state during this period.

¹The WPA Guide to 1930's Arkansas, 250.

UNITED STATES
DEPARTMENT OF THE INTERIOR
GEOLOGICAL SURVEY

7255 11 SE
(HARMONY)

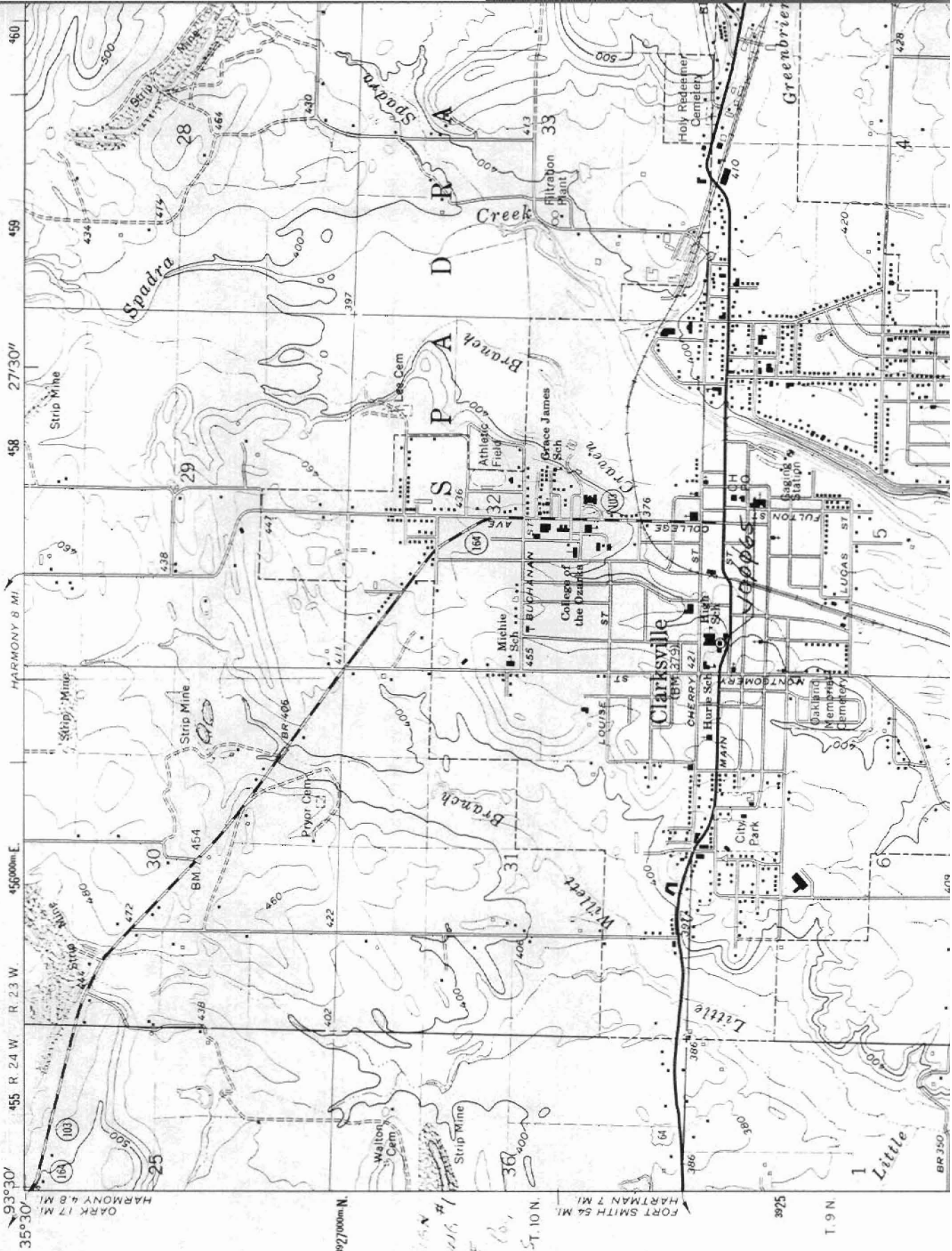

3927000m N
3925
T.9N
FORT SMITH 7 MI.
HARTMAN 54 MI.
15/457150/
3925220
V00065

93°30'
35°30'
DARK 17 MI.
HARMONY 4.8 MI.

450000m E

455 R 24 W R 23 W

HARMONY 8 MI

458 27°30'

460