

United States Department of the Interior
National Park Service

NATIONAL REGISTER OF HISTORIC PLACES
REGISTRATION FORM

=====

1. Name of Property

=====

Historic Name: Caney Springs Cumberland Presbyterian Church

Other Name/Site Number: IZ 0093

=====

2. Location

=====

Street & Number: NW of Int. AR Hwy 289 & Co. Rd. 70

Not for Publication: N/A

City/Town: Sage

Vicinity: X

State: AR

County: Izard

Code: AR 065

Zip Code: 72573

=====

3. Classification

=====

Ownership of Property: Private

Category of Property: Building

Number of Resources within Property:

Contributing	Noncontributing	
<u>1</u>	_____	buildings
_____	_____	sites
_____	_____	structures
_____	_____	objects
<u>1</u>	<u>0</u>	Total

Number of contributing resources previously listed in the National Register: N/A

Name of related multiple property listing: N/A

=====
4. State/Federal Agency Certification
=====

As the designated authority under the National Historic Preservation Act of 1986, as amended, I hereby certify that this X nomination _____ request for determination of eligibility meets the documentation standards for registering properties in the National Register of Historic Places and meets the procedural and professional requirements set forth in 36 CFR Part 60. In my opinion, the property X meets _____ does not meet the National Register Criteria. _____ See continuation sheet.

Atayn A. Sater
Signature of certifying official

4-12-95
Date

Arkansas Historic Preservation Program
State or Federal agency and bureau

In my opinion, the property _____ meets _____ does not meet the National Register criteria. _____ See continuation sheet.

Signature of commenting or other official

Date

State or Federal agency and bureau

=====
5. National Park Service Certification
=====

I, hereby certify that this property is:

- _____ entered in the National Register _____
_____ See continuation sheet.
- _____ determined eligible for the _____
National Register _____
_____ See continuation sheet.
- _____ determined not eligible for the _____
National Register _____
- _____ removed from the National Register _____
- _____ other (explain): _____

Signature of Keeper

Date
of Action

=====

6. Function or Use

=====

Historic: Religion Sub: Religious Facility

Current : Religion Sub: Religious Facility

=====

=====

7. Description

=====

Architectural Classification:

Other: Plain Traditional

=====

Materials: foundation Stone roof Metal
walls Weatherboard other Concrete

Describe present and historic physical appearance:

Summary

Constructed in 1889, the Caney Springs Cumberland Presbyterian Church is a Plain Traditional-styled, one-room frame building that is located at the intersection of Arkansas Highway 289 and County Road 70 in the Sage vicinity of IZARD County. The white-painted, weatherboard-clad building rests upon fieldstone piers and is covered with a corrugated-metal gable roof. The adjacent cemetery is not included in the nomination.

Elaboration

Constructed in 1889, the Caney Springs Cumberland Presbyterian Church is a Plain Traditional-styled, one-room frame building that rests upon fieldstone piers and is covered with a corrugated-metal gable roof. Built with virgin pine lumber from the area, the structure is clad with white-painted drop siding. The lone interior chimney has been capped. Although not included in the nomination, there is an active cemetery to the east of the church. Located just to the northwest of the intersection of Arkansas Highway 289 and County Road 70 approximately one mile north of Sage, the Caney Springs Cumberland Presbyterian Church has recently been restored and is in excellent condition.

The front, or southern, elevation is defined by two separate and symmetrical single-leaf entrances that are accessed by tall four-step concrete stoops. According to local tradition, the men entered through one doorway, and the woman through the other. Both side elevations are fenestrated by three one-over-one, double-hung windows, while the rear elevation contains a solitary one-over-one window and a single-leaf doorway at the northwest corner of the building.

The interior is roughly finished with plank flooring and flush horizontal board walls. Three wooden posts along the center of the church bolster the roof trusses above. The interior is divided into three sections by two aisles with the widest section of pews in the center. All of the pews were crafted by members of the congregation, and the unique outer pews are fitted into the wall. An original small, raised pulpit is located at the north end of the church. Currently, the interior exhibits seven kerosene lamps and holders that are replicas of the originals.

During the 106 years since its construction, the church has undergone few alterations. The original wood shake roof was replaced by the current metal roof at an unknown date, and the older members of the congregation recall that the original windows were multi-paned and were replaced during the historic period with the present one-over-one type. The front concrete steps were added in the 1930's. Technology has receded in one instance, however. The historically added electrical wiring was recently removed due to deterioration.

=====
8. Statement of Significance
=====

Certifying official has considered the significance of this property in relation to other properties: local.

Applicable National Register Criteria: C

Criteria Considerations (Exceptions): A

Areas of Significance: Architecture

Period(s) of Significance: 1889

Significant Dates: N/A

Significant Person(s): N/A

Cultural Affiliation: N/A

Architect/Builder: Unknown

State significance of property, and justify criteria, criteria considerations, and areas and periods of significance noted above:

Summary

The Caney Springs Cumberland Presbyterian Church is being nominated under Criterion C with local significance as the best example of a Plain Traditional-styled, one-room church building in the Sage vicinity of Izard County.

Elaboration

At the time of the construction of the Caney Springs Cumberland Presbyterian Church, Sage was apparently a small community and is noted in *The Goodspeed Biographical and Historical Memoirs of Northeastern Arkansas* only for having a post office. In *A History of Izard County*, Karr Shannon notes that the post office was established on August 11, 1887, and was first located on the "Felts place" about a mile southeast of the present town. It was moved in 1909. Sage is said to have been named for the tall sage grass that once grew in the area.

Goodspeed notes ten different congregations of the Cumberland Presbyterian Church in Izard County; however, Caney Springs is not listed in this 1889 publication as it was probably not completed at the time of writing.

The Caney Springs Cumberland Presbyterian Church derives its significance from its simple, yet refreshingly unaltered, one-room design with two separate entrances. This vernacular building type, often referred to as Plain Traditional style, was once common throughout Arkansas. Because it is the best example of this style remaining in the Sage vicinity of Izard County, the Caney Springs Cumberland Presbyterian Church is locally significant under Criterion C for its ability to express late nineteenth century vernacular style and construction techniques utilized in this area of the state.

=====
9. Major Bibliographical References
=====

Information submitted by Shirley Jennings and Sue Chrisco, August 1994.

The Goodspeed Biographical and Historical Memoirs of Northeastern Arkansas. Chicago, Nashville, and St. Louis: The Goodspeed Publishing Co., 1889.

Shannon, Karr. *A History of Izard County.* Little Rock: Democrat Printing and Lithographing Co., 1947.

Previous documentation on file (NPS):

- preliminary determination of individual listing (36 CFR 67) has been requested.
- previously listed in the National Register
- previously determined eligible by the National Register
- designated a National Historic Landmark
- recorded by Historic American Buildings Survey # _____
- recorded by Historic American Engineering Record # _____

Primary Location of Additional Data:

- X State historic preservation office
- Other state agency
- Federal agency
- Local government
- University
- Other -- Specify Repository: _____

=====

10. Geographical Data

=====

Acreage of Property: Less than one

UTM References: Zone Easting Northing Zone Easting Northing

A	<u>15</u>	<u>606340</u>	<u>3991180</u>	B	<u> </u>	<u> </u>	<u> </u>
C	<u> </u>	<u> </u>	<u> </u>	D	<u> </u>	<u> </u>	<u> </u>

Verbal Boundary Description:

The nominated boundary of the property is a rectangular parcel whose southeast corner is fifteen feet directly southeast of the southeast corner of the church and whose northwest corner is fifteen feet directly northwest of the northwest corner of the church

Boundary Justification:

This boundary includes the historic church building but excludes the adjacent cemetery.

=====

11. Form Prepared By

=====

Name/Title: Patrick Zollner, Architectural Historian

Organization: Arkansas Historic Preservation Program Date: April 5, 1995

Street & Number: 1500 Tower Bldg., 323 Center St. Telephone: (501) 324-9880

City or Town: Little Rock State: AR ZIP: 72201

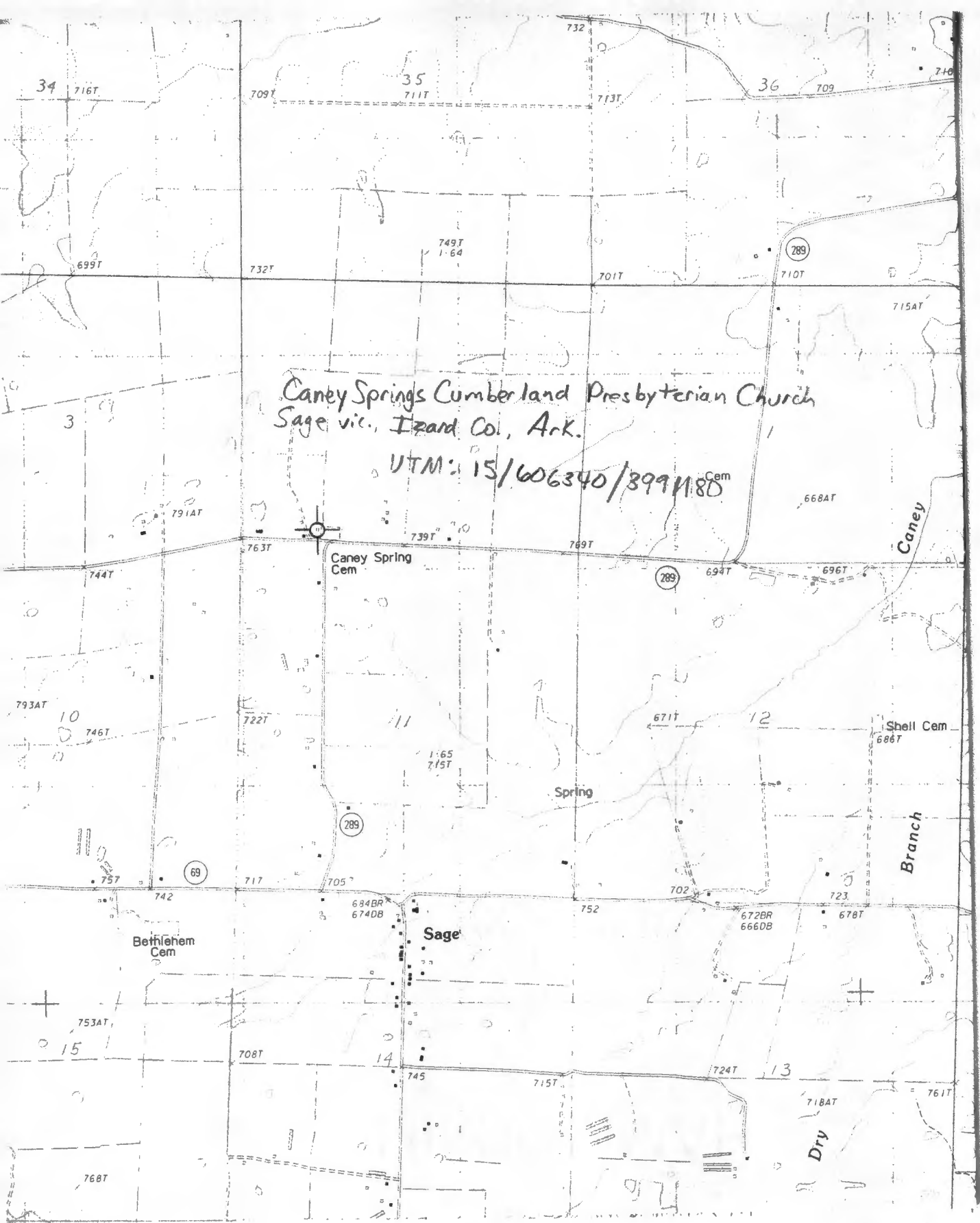

Caney Springs Cumberland Presbyterian Church
Sage vic., Izard Co., Ark.

UTM: 15/606340/3991180

Caney Spring
Cem

Bethlehem
Cem

Sage

Spring

Shell Cem
666T

Caney

Branch

Dry

