

United States Department of the Interior
National Park Service

Listed 7-20-01

National Register of Historic Places
Registration Form

This form is for use in nominating or requesting determinations for individual properties and districts. See instructions in *How to Complete the National Register of Historic Places Registration Form* (National Register Bulletin 16A). Complete each item by marking "x" in the appropriate box or by entering the information requested. If an item does not apply to the property being documented, enter "N/A" for "not applicable." For functions, architectural classification, materials, and areas of significance, enter only categories and subcategories from the instructions. Place additional entries and narrative items on continuation sheets (NPS Form 10-900a). Use a typewriter, word processor, or computer, to complete all items.

1. Name of Property

historic name Texaco Station No.1

other names/site number Hamburger Station (GE0026)

2. Location

street & number 110 E. Main Street

not for publication

city or town Paragould

vicinity

state Arkansas

code AR

county Greene

Code 055

zip code 72450

3. State/Federal Agency Certification

As the designated authority under the National Historic Preservation Act, as amended, I hereby certify that this nomination
request for determination of eligibility meets the documentation standards for registering properties in the National Register of Historic
Places and meets the procedural and professional requirements set for in 36 CFR Part 60. In my opinion, the property meets
does not meet the National Register criteria. I recommend that this property be considered significant
 nationally statewide locally. (See continuation sheet for additional comments.)

Catherine McQuinn

4/04/01

Signature of certifying official/Title

Date

Arkansas Historic Preservation Program

State or Federal agency and bureau

In my opinion, the property meets does not meet the National Register criteria. See Continuation sheet for additional
comments.)

Signature of certifying official/Title

Date

State or Federal agency and bureau

4. National Park Service Certification

I hereby certify that the property is:

entered in the National Register.

See continuation sheet

determined eligible for the
National Register.

See continuation sheet

determined not eligible for the
National Register.

removed from the National
Register.

other, (explain:)

Signature of the Keeper

Date of Action

5. Classification

Ownership of Property
(Check as many boxes as apply)

- private
- public-local
- public-State
- public-Federal

Category of Property
(Check only one box)

- building(s)
- district
- site
- structure
- object

Number of Resources within Property
(Do not include previously listed resources in count.)

Contributing	Noncontributing	
--------------	-----------------	--

1		buildings
		sites
		structures
		objects
1	0	Total

Name of related multiple property listing
(Enter "N/A" if property is not part of a multiple property listing.)

Arkansas Highway and Transportation Era Architecture, 1910-1965

Number of Contributing resources previously listed
in the National Register

N/A

6. Function or Use

Historic Functions
(Enter categories from instructions)

COMMERCE/TRADE/Specialty Store

Current Functions
(Enter categories from instructions)

COMMERCE/TRADE/Restaurant

7. Description

Architectural Classification
(Enter categories from instructions)

Mediterranean Revival

Materials
(Enter categories from instructions)

foundation CONCRETE

walls BRICK

roof TERRA COTTA

other

Narrative Description

(Describe the historic and current condition of the property on one or more continuation sheets.)

SEE CONTINUATION SHEET

8. Statement of Significance

Applicable National Register Criteria

(Mark "x" in one or more boxes for the criteria qualifying the property for National Register listing.)

- Criteria A, B, C, and D with checkboxes and descriptions.

Criteria Considerations

(Mark "x" in all the boxes that apply.)

Property is:

- Criteria A through G with checkboxes and descriptions.

Levels of Significance (local, state, national)

Local

Areas of Significance (Enter categories from instructions)

Transportation

Period of Significance

1924-1951

Significant Dates

1924

Significant Person (Complete if Criterion B is marked)

N/A

Cultural Affiliation (Complete if Criterion D is marked)

N/A

Architect/Builder

UNKNOWN

Narrative Statement of Significance

(Explain the significance of the property on one or more continuation sheets.)

SEE CONTINUATION SHEET

Texaco Station No. 1

Name of Property

Greene County, Arkansas

County and State

Major Bibliographical References

Bibliography

(Cite the books, articles, and other sources used in preparing this form on one or more continuation sheets.)

City Directory of Paragould. 1939.

Jakle, John A. and Keith A Sculle. The Gas Station in America. Johns Hopkins University Press, Baltimore. 1994.

Liebs, Chester H. Main Street to Miracle Mile. Little, Brown and Company, Boston. 1985.

Marky Collum, previous owner of the building. Telephone interview by Amy Bennett, 1 February 2001.

Mueller, Myrl Rhine. A History of Greene County, Arkansas. Parkhurst Book Design, Little Rock. 1984.

Paul West, previous renter of the building. Telephone interview by Amy Bennett, 23 January 2001.

Previous documentation on file (NPS):

- preliminary determination of individual listing (36 CFR 67) has been requested
previously listed in the National Register
Previously determined eligible by the National Register
designated a National Historic Landmark
recorded by Historic American Buildings Survey
#
recorded by Historic American Engineering Record #

Primary location of additional data:

- State Historic Preservation Office
Other State Agency
Federal Agency
Local Government
University
Other

Name of repository:

10. Geographical Data

Acreege of Property Less than one acre.

UTM References

(Place additional UTM references on a continuation sheet.)

Table with 4 columns: Reference, Zone, Easting, Northing. Contains data for references 1, 2, 3, and 4.

See continuation sheet

Verbal Boundary Description

(Describe the boundaries of the property on a continuation sheet.)

The boundary of Texaco Station No. 1 located in Section 31, Range 6 E, Township 17N. Beginning at a point formed by the intersection of the Eastern curb of South Pruett Street and a line formed by the rear, or southern, elevation of the drive-thru window addition, proceed east along this line approximately 70 feet to a point formed by the intersection of said line and an imaginary line that runs South West to North East parallel the railroad tracks; turn and proceed North East along said line to the intersection of this line and the southern curb of East Main Street; turn and proceed East along the curb to the intersection with the western curb of South Pruett Street; then proceed south along the curb to the point of beginning.

Boundary Justification

(Explain why the boundaries were selected on a continuation sheet.)

The nominated property includes the entire parcel historically associated with the Texaco Station No. 1.

1. Form Prepared By

name/title Amy Bennett/Survey Historian
organization Arkansas Historic Preservation Program Date 3/15/01
street & number 323 Center Street, 1500 Tower Building Telephone (501) 324-9874
city or town Little Rock state Arkansas zip code 72201

United States Department of the Interior
National Park Service

National Register of Historic Places Continuation Sheet

Section number 7 Page 1

SUMMARY

The Texaco Station No. 1 (now known as the Hamburger Station) at the northwest corner of Main Street and Pruett Street is situated just outside of the historic commercial district of Paragould. One block to the west of the building is US Hwy 49B, and two blocks to the south are Arkansas Highways 412 and 69. Making use of the building's prominent location, the station now serves as a restaurant. The brick building, constructed circa 1925, is a good example of a small "house-with-canopy" Mission-influenced gas station with a small frame addition on the rear of its one-room core. A hipped roof covers the entire structure.

ELABORATION

Located at 110 East Main Street, the Texaco Station No. 1 is a single-story, rectangular plan station of the "house-with-canopy" type that predominated in early gas station design. Resting upon a continuous concrete foundation, the "house" and dual columns are constructed of brick that is now painted white and red. The original color of the brick was reddish brown and accentuated on the corners by buff bricks laid in a quoin effect. Beaded board covers the soffit of the eaves. The pairs of brackets that decorate the corners of the roofline and the terra cotta tile hipped roof are the major Mission-influenced details of the building. One exterior brick chimney pierces the wide eave overhang of the roof on the rear elevation. After the location was abandoned by the Texaco franchise, the building was leased as a small used car lot, and in the 1980s reused as a restaurant.

North/Front Elevation

The front façade is dominated by the car shelter that is supported by a pair of brick columns. Beneath the hipped roof canopy, where people once parked their cars and full-service gas station attendants once escaped the weather, customers of the restaurant can now enjoy their lunches on a pair of picnic tables. Situated between a pair of single-pane stationary windows (one infilled by a large menu), is a doorway that has been retrofitted with a small service window.

West and East Elevations

The side elevations were originally identical. When the building was rehabilitated into a restaurant, a window was infilled on the east elevation.

South Elevation

The rear elevation contains the 1985 addition to the building, and a window near the southwest corner contains a window that was infilled to install a stove vent. The vertical board addition is positioned over the original exterior access near the southeast corner of the main building. The gable roof addition contains the drive-thru window, a preparation area, and storage facilities. The addition is fenestrated by double-hung, one-over-one, aluminum frame windows on its south and west elevations. The south window also functions as the drive-thru pick-up window.

United States Department of the Interior
National Park Service

National Register of Historic Places Continuation Sheet

Section number 8 Page 1

SUMMARY

Constructed circa 1925, the Texaco Station No. 1 (since 1985 known as the Hamburger Station) is being nominated with local significance under Criterion A for its association with the development of Arkansas highway culture in Paragould. As one of only two remaining historic gas stations in Paragould, it is being submitted under the multiple property listing "Arkansas Highway and Transportation Era Architecture, 1910-1965" in conjunction with the historic context "Arkansas Highway History and Architecture, 1910-1965."

ELABORATION

By 1920, Paragould had grown into a thriving town of 6,306 people. Greene County's vibrant timber industry was made possible by the transportation afforded by its two railroads (known in 1920 as the Missouri Pacific and the St. Louis and Southwestern or "Cotton Belt"). The town could boast of four bands, two department stores (one containing three stories), two newspapers, a pressed brick factory, a tile factory, and ice and cold storage plant, a flour mill, two spoke factories, three cotton gins, the Missouri Pacific railroad shops, a post office, an 800-seat theater, a telephone exchange, and other assorted businesses. Paragould also claimed one of the finest hotels in Arkansas, the Vandervoort. In light of the town's prosperity, the Chamber of Commerce proudly adopted as its slogan "You'll like Paragould."

Although the railroads spawned the town of Paragould and provided economic growth in conjunction with the timber industry, a new mode of transportation, the automobile, had become popular for many people in Paragould and the surrounding countryside. Among the changes to the town's landscape brought on by the mass use of the automobile was the gas station. Nationwide, gasoline had been sold at various Main Street retail businesses before the advent of the gas station. According to John Jakle and Keith A. Sculle in *The Gas Station in America*, this new commercial building species would be found in every town and city in the county.

Olan Lewis was the first owner and operator of the Texaco Station in 1924. However by 1939, according to the Paragould City Directory, the Texaco Station No. 1 was owned and operated by E. D. Woodburn, who also owned the Texaco Station No. 2 located at Second and Poplar. As stated by Paul West a long time resident of the area, since the mid-1940s the gas station has changed products a number of times including Esso and Standard Oil. He also remembers it being used as a bus station. Paul West ran a used car dealership out of the building for fifteen years before it was sold on 1 October 1985, to Dottie Biddick and Marky Collum. They began the Hamburger Station restaurant and drive-thru after making an addition to the rear of the building. Marky Collum remembers that the only change they made to the building was the installation of cabinets, and a stove-the exterior was already painted white and red and the single pane stationary windows were previously installed. The current owner, Bert Daggett worked for the restaurant a number of years, and purchased the business in 1998.

United States Department of the Interior
National Park Service

National Register of Historic Places Continuation Sheet

Section number 8 Page 2

Significance

Constructed in 1924, the Texaco Station No. 1 is being nominated with local significance under Criterion A as a good example of an automobile-related building in Paragould. The building is significant for its association with the transportation culture and is being submitted under the multiple property listing "Arkansas Highway and Transportation Era Architecture, 1910-1965" in conjunction with the historic context "Arkansas Highway History and Architecture, 1910-1965."

Texaco Station No.1
Greene Co., AR
UTM Reference:
16S47/3992717

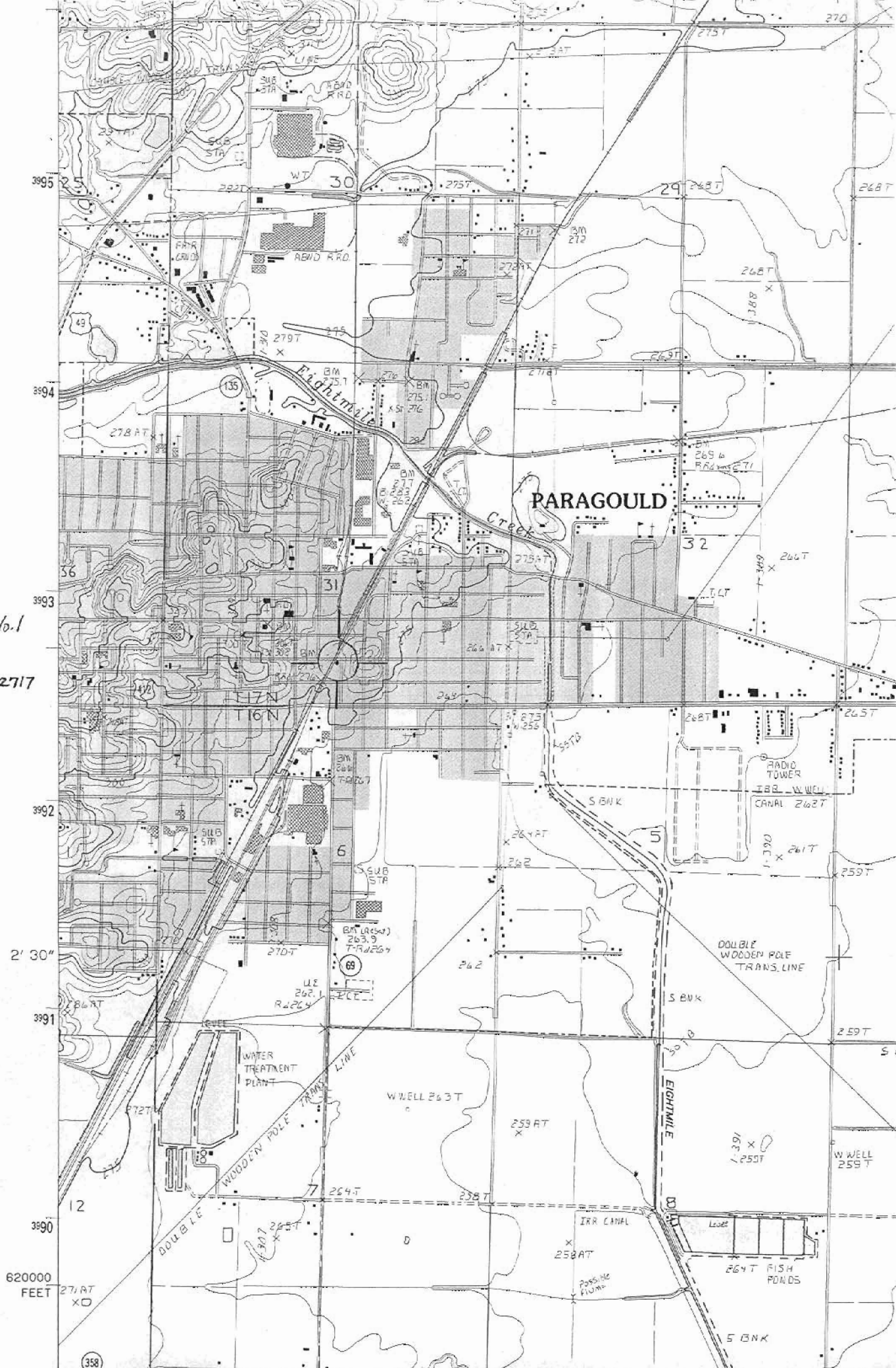

620000
FEET

358



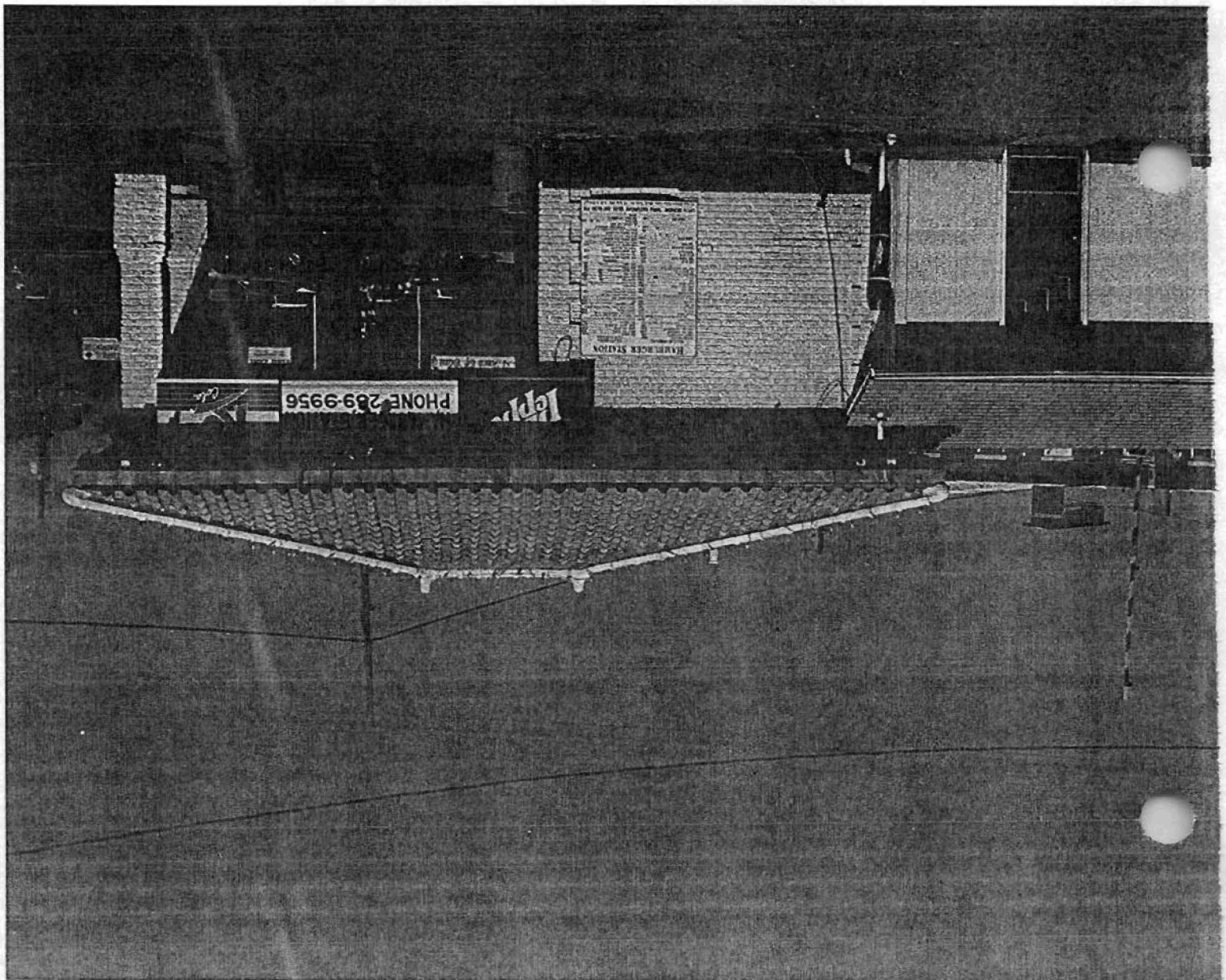



HAMBURGER STATION
PHONE 239-9956

RC
Cola

HAMBURGER STATION
PHONE 239-9956

Dr Pepper

