

United States Department of the Interior  
National Park Service

NR LISTED  
DEC 6 1996

AHPP

NATIONAL REGISTER OF HISTORIC PLACES  
REGISTRATION FORM

1. Name of Property

historic name: Confederate Section, Hollywood Cemetery

other name/site number: GA0147

2. Location

street & number: Near intersection of Hollywood Avenue and Mote Road

not for publication: N/A

city/town: Hot Springs

vicinity: N/A

state: AR county: Garland code: AR 051 zip code: 71901

3. Classification

Ownership of Property: Private

Category of Property: Site

Number of Resources within Property:

Contributing	Noncontributing	
<u>1</u>	<u>3</u>	buildings
<u>1</u>	<u>1</u>	sites
<u>35</u>	<u>4</u>	structures
<u>37</u>	<u>4</u>	objects
	<u>4</u>	Total

Confederate Section, Hollywood Cemetery  
Name of Property

Garland County, AR  
County and State

Number of contributing resources previously listed in the National Register: N/A

Name of related multiple property listing: "Something So Dim It Must Be Holy": Civil War Commemorative Sculpture in Arkansas, 1886-1934

=====  
**4. State/Federal Agency Certification**  
=====

As the designated authority under the National Historic Preservation Act of 1986, as amended, I hereby certify that this X nomination \_\_\_\_\_ request for determination of eligibility meets the documentation standards for registering properties in the National Register of Historic Places and meets the procedural and professional requirements set forth in 36 CFR Part 60. In my opinion, the property X meets \_\_\_\_\_ does not meet the National Register Criteria. \_\_\_\_\_ See continuation sheet

Cathryn A. Slater \_\_\_\_\_ 10-11-96  
Signature of certifying official Date

Arkansas Historic Preservation Program  
State or Federal agency and bureau

In my opinion, the property X meets \_\_\_\_\_ does not meet the National Register criteria. \_\_\_\_\_ See continuation sheet.

\_\_\_\_\_  
Signature of commenting or other official Date

\_\_\_\_\_  
State or Federal agency and bureau

=====  
**5. National Park Service Certification**  
=====

I, hereby certify that this property is:

\_\_\_\_\_ entered in the National Register \_\_\_\_\_

Name of Property

County and State

See continuation sheet.  
 determined eligible for the National Register \_\_\_\_\_  
 See continuation sheet.  
 determined not eligible for the National Register \_\_\_\_\_  
 removed from the National Register \_\_\_\_\_  
 other (explain): \_\_\_\_\_  
\_\_\_\_\_  
\_\_\_\_\_  
\_\_\_\_\_  
\_\_\_\_\_  
\_\_\_\_\_  
\_\_\_\_\_  
\_\_\_\_\_  
\_\_\_\_\_  
Signature of Keeper Date  
of Action

=====

**6. Function or Use**

=====

Historic: RECREATION AND CULTURE Sub: Monument/marker  
FUNERARY Cemetery  
\_\_\_\_\_  
\_\_\_\_\_  
Current: RECREATION AND CULTURE Sub: Monument/marker  
FUNERARY Cemetery  
\_\_\_\_\_  
\_\_\_\_\_

=====

**7. Description**

=====

Architectural Classification:

Rustic  
\_\_\_\_\_  
\_\_\_\_\_

Other Description: N/A

Materials:	foundation	<u>Fieldstone/Concrete</u>	roof	<u>N/A</u>
	walls	<u>Fieldstone/Marble</u>	other	<u>N/A</u>

Describe present and historic physical appearance.  See continuation sheet.

Confederate Section, Hollywood Cemetery

Name of Property

Garland County, AR

County and State

---

### **Summary**

The Confederate Section, Hollywood Cemetery at Hot Springs in Garland County is a 60-foot by 54-foot cemetery plot surrounded by a low concrete wall with ornamental concrete posts at all four corners and an opening on the western side inscribed "Confederate Veterans." The plot contains 34 marked burials, a fieldstone monument, and four non-historic concrete benches.

### **Elaboration**

The Confederate Section, Hollywood Cemetery at Hot Springs in Garland County is a 60-foot by 54-foot cemetery plot surrounded by a low concrete wall with ornamental concrete posts at all four corners and an opening inscribed "Confederate Veterans." The plot contains 34 marked burials, a fieldstone monument, and four non-historic concrete benches.

The Confederate Section is located at the western edge of the cemetery, just south of the intersection of Hollywood and Mote streets.

The most prominent feature of the plot is a fieldstone monument -- 8' tall, 20' wide and 4' deep -- located in the center of the southern end of the plot. The monument is a rectangular monolith of rusticated granite stones joined with grapevine mortaring. It has an inset, oval, marble slab inscribed: OUR CONFEDERATE DEAD. A concrete band near the bottom of the monument is inscribed with the date 1919.

Four concrete benches are arranged around the monument. They date from 1974 and are non-contributing.

There are 34 burial markers in the plot. About seven are scattered around the southern end, but the majority are located in the northern end of the plot. Most are simple marble markers, but there are a few larger gravestones. One grave site is surrounded by a low wall, and two are box tombs. Two large trees are located in the northern end.

The site is well maintained and the majority of the markers are in good condition.

Confederate Section, Hollywood Cemetery  
Name of Property

Garland County, AR  
County and State

=====  
**8. Statement of Significance**  
=====

Certifying official has considered the significance of this property in relation to other properties: Statewide.

Applicable National Register Criteria: A

Criteria Considerations (Exceptions): C,F

Areas of Significance: SOCIAL HISTORY  
\_\_\_\_\_  
\_\_\_\_\_  
\_\_\_\_\_  
\_\_\_\_\_

Period(s) of Significance: 1900-1935

Significant Dates: 1919

Significant Person(s): N/A  
\_\_\_\_\_

Cultural Affiliation: N/A

Architect/Builder: Unknown  
\_\_\_\_\_  
\_\_\_\_\_

State significance of property, and justify criteria, criteria considerations, and areas and periods of significance noted above.  
\_\_\_ See continuation sheet.

**Summary**                      Criterion A, statewide significance  
                                    Criteria Considerations C and F

The Confederate Section, Hollywood Cemetery is associated with the historic context "Something So Dim It Must Be Holy": Civil War Commemorative Sculpture

In Arkansas, 1886-1934 as a commemorative monument and burial plot financed through the efforts of ancestral organizations in Arkansas. As such, it is eligible under Criterion A with statewide significance for its associations with the efforts of the Albert Pike Camp of United Confederate Veterans and Hot Springs Chapter #80 of the United Daughters of the Confederacy to reflect members' perception of the noble character and valor of their veterans and their cause. Thus, it also meets the eligibility requirements of Criteria Consideration C: Cemeteries, and Criteria Consideration F: Commemorative Properties.

### **Elaboration**

The Confederate Section, Hollywood Cemetery was purchased in 1900 by David Stone Ryan, who served as a lieutenant in a North Carolina unit during the Civil War and later made a home in Hot Springs. Ryan, commander of the Albert Pike Camp, United Confederate Veterans, bought the plot to ensure a final resting place for his fellow aging veterans.

The Albert Pike Camp was disbanded in June 1906, and camp members voted to transfer ownership of the plot to Hot Springs Chapter #80 of the United Daughters of the Confederacy to "take charge of, enclose and keep repaired." (The deed to the 30 lots in Block A of Hollywood Cemetery was not officially recorded, however, until June 18, 1953.)

After receiving control of the plot, the members of Chapter #80 worked for 13 years to purchase a Confederate monument for the plot. The project was completed in 1919, with the erection of the impressive granite monument that stands in the southern end of the plot.

Chapter #80 continued fund-raising activities after the Hollywood Cemetery monument was erected. On June 2, 1934, a marble monument topped by a lone Confederate soldier (Hot Springs Confederate Monument, NR 4/26/96) was dedicated at the center of Como Square (now Landmark Plaza) in downtown Hot Springs. A year later, the chapter purchased nine headstones on previously unmarked graves in the Confederate Section, Hollywood Cemetery.

Four concrete benches were placed in the plot by the UDC in 1974, and Chapter #80, the Chadwick Butterworth Chapter of the UDC and a local Sons of Confederate Veterans chapter hold a joint memorial service at the cemetery each year.

Confederate Section, Hollywood Cemetery  
Name of Property

Garland County, AR  
County and State

Although less prominent than the Hot Springs Confederate Monument in downtown Hot Springs, the Confederate Section, Hollywood Cemetery remains an important link to early efforts to commemorate the "Lost Cause" in Garland County. As the sole remaining historic resource associated with the long-defunct Albert Pike Camp of the United Confederate Veterans and the resource most closely associated with the early efforts of Hot Springs Chapter #80 of the United Daughters of the Confederacy, it is worthy of National Register recognition.

The Confederate Section, Hollywood Cemetery is associated with the historic context "Something So Dim It Must Be Holy": Civil War Commemorative Sculpture in Arkansas, 1886-1934 as a commemorative monument and burial plot financed through the efforts of ancestral organizations in Arkansas. As such, it is eligible under Criterion A with statewide significance for its associations with the efforts of the Albert Pike Camp of United Confederate Veterans and Hot Springs Chapter 80 of the United Daughters of the Confederacy to reflect members' perception of the noble character and valor of their veterans and their cause. Thus, it also meets the eligibility requirements of Criteria Consideration C: Cemeteries, and Criteria Consideration F: Commemorative Properties.

=====  
**. Major Bibliographical References**  
=====

Materials submitted by Mrs. Jimmie L. Jones, Hot Springs Chapter #80, United Daughters of the Confederacy.

Strangstad, Lynette, A Graveyard Preservation Primer, American Association for State and Local History, 1988, p. 109.

\_\_\_ See continuation sheet.

Previous documentation on file (NPS):

- preliminary determination of individual listing (36 CFR 67) has been requested.
- previously listed in the National Register
- previously determined eligible by the National Register
- designated a National Historic Landmark
- recorded by Historic American Buildings Survey # \_\_\_\_\_
- recorded by Historic American Engineering Record # \_\_\_\_\_

Primary Location of Additional Data:

- X State historic preservation office
- Other state agency
- Federal agency
- Local government
- University
- Other -- Specify Repository: \_\_\_\_\_

=====

**10. Geographical Data**

=====

Acreage of Property: Less than one

UTM References:	Zone	Easting	Northing	Zone	Easting	Northing
A	<u>15</u>	<u>496100</u>	<u>3815880</u>	B	<u>15</u>	_____
C	<u>15</u>	_____	_____	D	<u>15</u>	_____

\_\_\_ See continuation sheet.

Verbal Boundary Description: \_\_\_ See continuation sheet.

An area around the site defined by a line running around the exterior of the associated concrete wall.

Boundary Justification: \_\_\_ See continuation sheet.

This boundary includes all the property historically associated with this resource.



Confederate Section, Hollywood Cemetery

Name of Property

Garland County, AR

County and State

=====  
**11. Form Prepared By**  
=====

Name/Title: Mark Christ, Communications/Development Director

Organization: Arkansas Historic Preservation Program Date: 10/02/96

Street & Number: 323 Center Street, Suite 1500 Telephone: (501) 324-9880

City or Town: Little Rock State: AR Zip: 72201

HOT SPRINGS SOUTH QUADRANGLE  
 ARKANSAS  
 7.5 MINUTE SERIES (TOPOGRAPHIC)

93° 00' 34" 30"

499

498

1 690 000 FEET

497

496 2' 30"

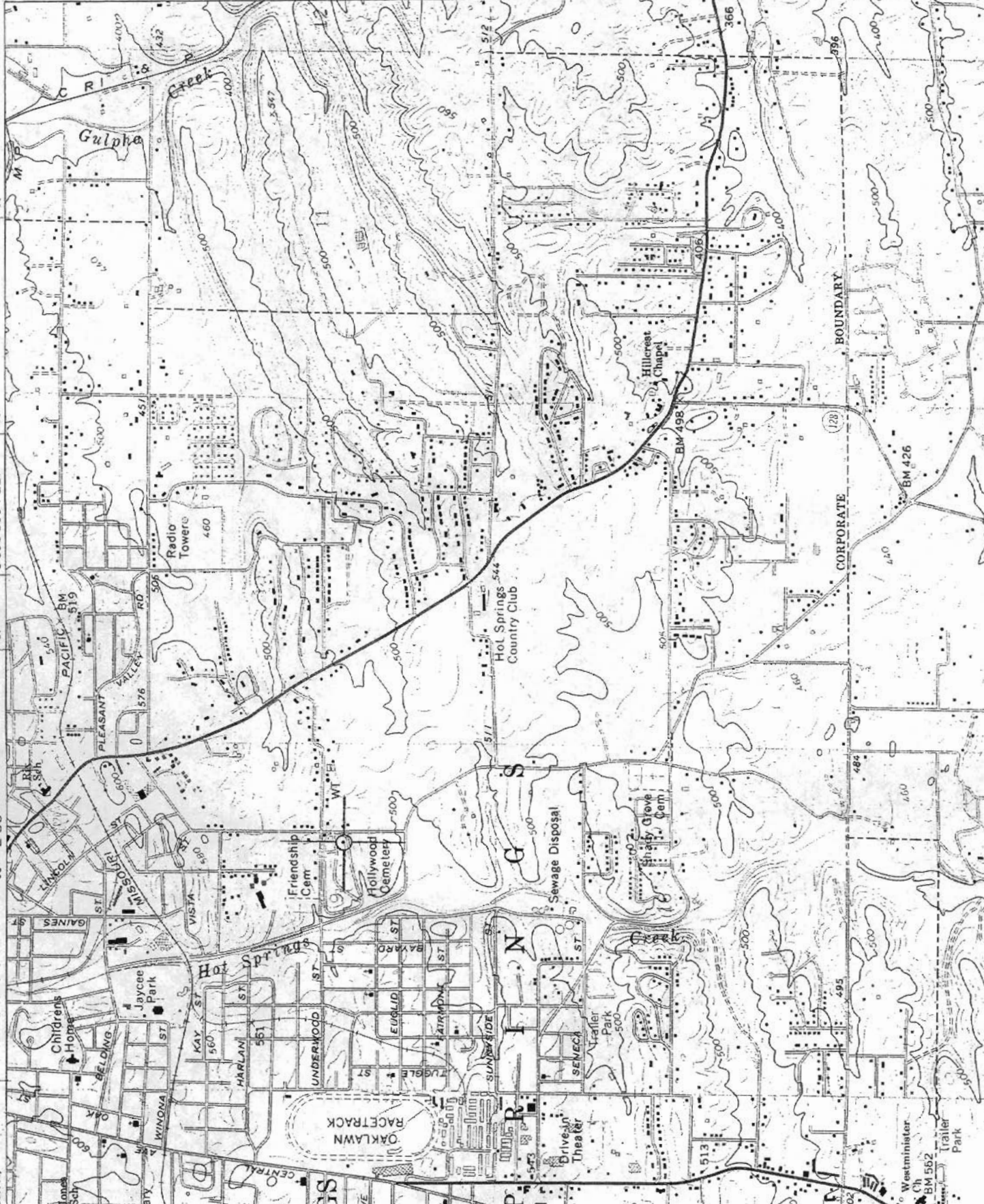

3817

3816

CONFEDERATE  
 SECTION  
 HOLLAND C.M.  
 HOT SPRINGS,  
 AR

15/496100/  
 3815 3815 880

660 000  
 FEET

3813

Westminister  
 Ch  
 BM 552  
 Trailer Park