

United States Department of the Interior  
National Park Service

NRListed: 5-24-04

### National Register of Historic Places Registration Form

This form is for use in nominating or requesting determinations for individual properties and districts. See instructions in *How to Complete the National Register of Historic Places Registration Form* (National Register Bulletin 16A). Complete each item by marking "X" in the appropriate box or by entering the information requested. If an item does not apply to the property being documented, enter "N/A" for "not applicable." For functions, architectural classification, materials, and areas of significance, enter only categories and subcategories from the instructions. Place additional entries and narrative items on continuation sheets (NPS Form 10-900a). Use a typewriter, word processor, or computer, to complete all items.

#### 1. Name of Property

historic name Harden Family Cemetery

other names/site number Site #CH0178. Site #3CH176

#### 2. Location

street & number Hardin Road  not for publication

city or town Jennie  vicinity

state Arkansas code AR county Chicot code 017 zip code 71653

#### 3. State/Federal Agency Certification

As the designated authority under the National Historic Preservation Act, as amended, I hereby certify that this  nomination   
request for determination of eligibility meets the documentation standards for registering properties in the National Register of Historic  
Places and meets the procedural and professional requirements set for in 36 CFR Part 60. In my opinion, the property  meets   
does not meet the National Register criteria. I recommend that this property be considered significant  
 nationally  statewide  locally. (See continuation sheet for additional comments.)

*Carrie Matthews*

4/8/04

Signature of certifying official/Title

Date

Arkansas Historic Preservation Program

State or Federal agency and bureau

In my opinion, the property  meets  does not meet the National Register criteria. ( See Continuation sheet for additional  
comments.)

Signature of certifying official/Title

Date

State or Federal agency and bureau

#### 4. National Park Service Certification

I hereby certify that the property is:

entered in the National Register.

See continuation sheet

determined eligible for the  
National Register.

See continuation sheet

determined not eligible for the  
National Register.

removed from the National  
Register.

other, (explain): \_\_\_\_\_

Signature of the Keeper

Date of Action

\_\_\_\_\_  
\_\_\_\_\_  
\_\_\_\_\_  
\_\_\_\_\_

Harden Family Cemetery  
Name of Property

Chicot County, Arkansas  
County and State

**5. Classification**

**Ownership of Property**  
(Check as many boxes as apply)

- private
- public-local
- public-State
- public-Federal

**Category of Property**  
(Check only one box)

- building(s)
- district
- site
- structure
- object

**Number of Resources within Property**  
(Do not include previously listed resources in count.)

Contributing                      Noncontributing

_____	buildings
_____	sites
_____	structures
_____	objects
_____	Total

**Name of related multiple property listing**  
(Enter "N/A" if property is not part of a multiple property listing.)

Historic and Architectural Resources Associated with the  
Ethnic and Racial Minority Settlement of the Arkansas Delta

**Number of Contributing resources previously listed  
in the National Register**

\_\_\_\_\_

**6. Function or Use**

**Historic Functions**  
(Enter categories from instructions)

FUNERARY/Cemetery  
\_\_\_\_\_  
\_\_\_\_\_  
\_\_\_\_\_  
\_\_\_\_\_  
\_\_\_\_\_  
\_\_\_\_\_

**Current Functions**  
(Enter categories from instructions)

FUNERARY/Cemetery  
\_\_\_\_\_  
\_\_\_\_\_  
\_\_\_\_\_  
\_\_\_\_\_  
\_\_\_\_\_  
\_\_\_\_\_

**7. Description**

**Architectural Classification**  
(Enter categories from instructions)

N/A  
\_\_\_\_\_  
\_\_\_\_\_

**Materials**  
(Enter categories from instructions)

foundation N/A  
walls N/A  
roof N/A  
other STONE  
\_\_\_\_\_

**Narrative Description**

(Describe the historic and current condition of the property on one or more continuation sheets.)

8. Statement of Significance

Applicable National Register Criteria

(Mark "x" in one or more boxes for the criteria qualifying the property for National Register listing.)

- Criteria A, B, C, D with checkboxes and descriptions of property significance.

Criteria Considerations

(Mark "x" in all the boxes that apply.)

Property is:

- Criteria A through G with checkboxes and descriptions of property characteristics.

Levels of Significance (local, state, national)

LOCAL

Areas of Significance (Enter categories from instructions)

EXPLORATION/SETTLEMENT

ETHNIC HERITAGE/Black

Period of Significance

1892-1947

Significant Dates

1892-1947

Significant Person (Complete if Criterion B is marked)

Cultural Affiliation (Complete if Criterion D is marked)

Architect/Builder

Narrative Statement of Significance

(Explain the significance of the property on one or more continuation sheets.)

9. Major Bibliographical References

Bibliography

(Cite the books, articles, and other sources used in preparing this form on one or more continuation sheets.)

Previous documentation on file (NPS):

- Documentation checkboxes: preliminary determination, previously listed, National Register, National Historic Landmark, Historic American Buildings Survey, Historic American Engineering Record.

Primary location of additional data:

- Location checkboxes: State Historic Preservation Office, Other State Agency, Federal Agency, Local Government, University, Other.

Name of repository:



United States Department of the Interior  
National Park Service

## National Register of Historic Places Continuation Sheet

Section number 7 Page 1

### SUMMARY

The Harden Family Cemetery, which contains 14 marked graves, is located on Hardin Road approximately one mile north of Jennie, Arkansas, in Chicot County. The small rural cemetery is in the middle of a horse pasture, and is not visible from the road. In addition, it is not labeled on the USGS topographic map for the area.

### ELABORATION

The Harden Family Cemetery is located in rural Chicot County, approximately one mile north of Jennie. The cemetery is located in a horse pasture at the edge of a wooded area, and is not visible from Hardin Road. In addition to the 14 marked graves, a number of unmarked graves are also present.

The Harden Family Cemetery has gravestones ranging from tablets to small obelisks. The stones are carved with various styles of script, and a few stones have pictures, including Bibles. In addition, three of the stones ve the insignia of the Royal Circle of Friends.

Until recently the cemetery was overgrown, but members of the family cleared away the shrubbery and vegetation in August 2003.

This is a breakdown of burials by decade of the 14 marked graves:

1890s – 1

1910s – 2

1920s – 2

1950s – 3

1960s – 2

Unknown – 3 (Although three stones have unknown burial dates, the style of the stones and their weathering indicates that they are historic burials.)

Person is still living – 1

United States Department of the Interior  
National Park Service

## National Register of Historic Places Continuation Sheet

Section number 8 Page 1

### SUMMARY

The Harden Family Cemetery is being nominated to the National Register of Historic Places with **local significance** under **Criterion A** for its association with early settlement in the Jennie vicinity of Chicot, County. Members of the Harden Family were prominent early African-American settlers in the Jennie area, and involved in many aspects of Jennie community life, and the cemetery represents the most significant remaining site associated with the Harden family. As a result, it is also being nominated under **Criterion B** along with **Criteria Consideration C: birthplaces or graves**. The cemetery is also being nominated under **Criteria Consideration D: cemeteries** and under the multiple property listing "Historic and Architectural Resources Associated with the Ethnic and Racial Minority Settlement of the Arkansas Delta."

### ELABORATION

Much of the history of the Jennie area is unknown, although it was apparently originally known as Downsville. Although a railroad line parallels Arkansas Highway 159 through the settlement, it was not built until after 1895. Likely the development of Jennie (or Downsville) occurred just after the arrival of the railroad line.

The Harden Family included some of the early settlers in the Jennie area, and they played prominent roles in the life of the community. John Harden, Sr., was the family patriarch. Although little is known about his life, it is known that he was a slave. He was freed after the Emancipation Proclamation and lived out the remainder of his life in the Jennie area before he died on April 14, 1892.

John Harden, and his wife Mary Thomas Harden, had three sons, Sam P. Harden, John Silas Harden, and Henry Harden. They were the founders of the community and were known as the preacher, politician, and teacher. Sam P. Harden was the pastor of Pleasant Hope Baptist Church, which was located just north of Jennie and about one-half mile west of the cemetery. He was pastor in April 1927 when William H. Harden, his nephew, joined the church. John Silas Harden was the teacher and taught reading, writing, and arithmetic in the one-room schoolhouse in Jennie. Henry Harden, who was known as the politician, died March 8, 1927. (According to members of the family, Henry never held any elective office, but was known as the politician because of his civic-minded nature.)

In addition to the three sons John and Mary Thomas Harden also had a daughter, Moriah. She married General James who was born in 1897, and is also buried in the cemetery. He died on October 10, 1918, while at Camp Funston, Kansas, where he was stationed in preparation for deportation to Europe for service in World War I.

Henry Harden, and his wife Mary, had two sons, William H. and John A Harden. William H. Harden was born August 29, 1889, on the Henry Harden place in the Downsville Settlement (now Jennie). William entered Philander Smith College in Little Rock in 1905, and completed his coursework in English in 1908.

United States Department of the Interior  
National Park Service

## National Register of Historic Places Continuation Sheet

Section number 8 Page 2

He returned to Jennie the following year. In 1930 he was appointed a census enumerator by the Honorable Robert Zebold of Pine Bluff, who was the superintendent of the census. He died May 25, 1947.

John A. Harden served as the first black postmaster of Jennie, Arkansas. (Although it is not known when he took the position of postmaster, the post office in Jennie was established in 1905.) In 1910 he was the owner of the general merchandise store and post office, and he died on August 16, 1917.

John A. and John Silas Harden were also members of the Royal Circle of Friends. The Royal Circle of Friends, which was a benevolent society, was organized in Helena, Arkansas, in 1909 by Dr. R. A. Williams. By 1918 the circle had 25, 000 members in five states. According to church members it cost \$5 to join and the dues were \$1 every two months. As a benevolent society the circle paid hospital bills and burial expenses.

Although Jennie has always remained a small settlement, the Harden family has been an important family in the community's history. From teachers to preachers and postmasters, the Harden family has been involved in many aspects of Jennie's community life. The Harden Family Cemetery remains today as the final resting place of many of the Harden family's most prominent members.

### STATEMENT OF SIGNIFICANCE

The Harden Family Cemetery is being nominated to the National Register of Historic Places with **local significance** under **Criterion A** for its association with early settlement in the Jennie vicinity of Chicot, County. Members of the Harden Family were prominent early African-American settlers in the Jennie area, and involved in many aspects of Jennie community life, and the cemetery represents the most significant remaining site associated with the Harden family. As a result, it is also being nominated under **Criterion B** along with **Criteria Consideration C: birthplaces or graves**. The cemetery is also being nominated under **Criteria Consideration D: cemeteries** and under the multiple property listing "Historic and Architectural Resources Associated with the Ethnic and Racial Minority Settlement of the Arkansas Delta."

United States Department of the Interior  
National Park Service

## National Register of Historic Places Continuation Sheet

Section number 9 Page 1

---

### BIBLIOGRAPHY

Baker, Russell Pierce. *From Memdag to Norsk: A Historical Directory of Arkansas Post Offices, 1832-1971*. Hot Springs, AR: Arkansas Genealogical Society, 1988.

*Cram's Township and Rail Road Map of Arkansas*. Map. Chicago: George Franklin Cram, 1895.

Goodson, Lori. *Pandemic*. The Manhattan Mercury, 1998. Found at [www2.okstate.edu/ww1hist/flu.html](http://www2.okstate.edu/ww1hist/flu.html).

Harden, William H. *Autobiography*. Jennie, Arkansas, written June 1936.

Jeter, Marvin, Ph.D. E-mail to Gwen Perry 5 September 2003.

Johnson, Ida B. Harden. *Harden Roots / Oral History Handout*. (Family historian and daughter of William H. Harden), Family Reunion, 2001.

Perry, Gwen. Letter to Dr. Ann Early, State Archaeologist – Arkansas Archaeological Survey, 25 August 2003.



Harden Family Cemetery  
Name of Property

Chicot County, Arkansas  
County and State

United States Department of the Interior  
National Park Service

## National Register of Historic Places Continuation Sheet

Section number 10 Page 1

---

### VERBAL BOUNDARY DESCRIPTION

The Harden Family Cemetery is located in the northwest part of the NW  $\frac{1}{4}$ , NE  $\frac{1}{4}$  of Section 35, Township 16 South, Range 2 West.

### BOUNDARY JUSTIFICATION

The boundary contains all of the land historically associated with the Harden Family Cemetery.



MEMBER OF  
FRIENDS  
LOVED

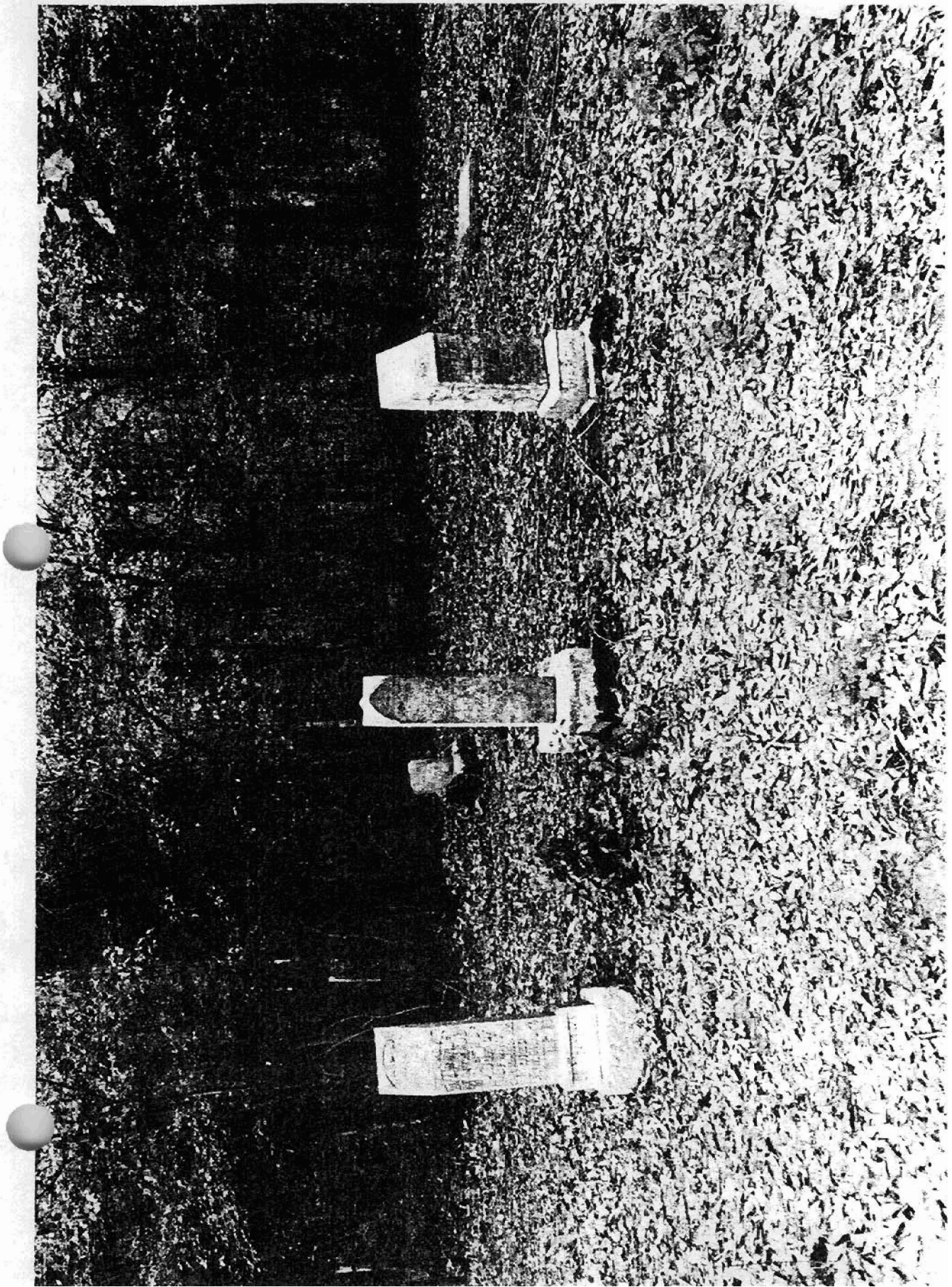

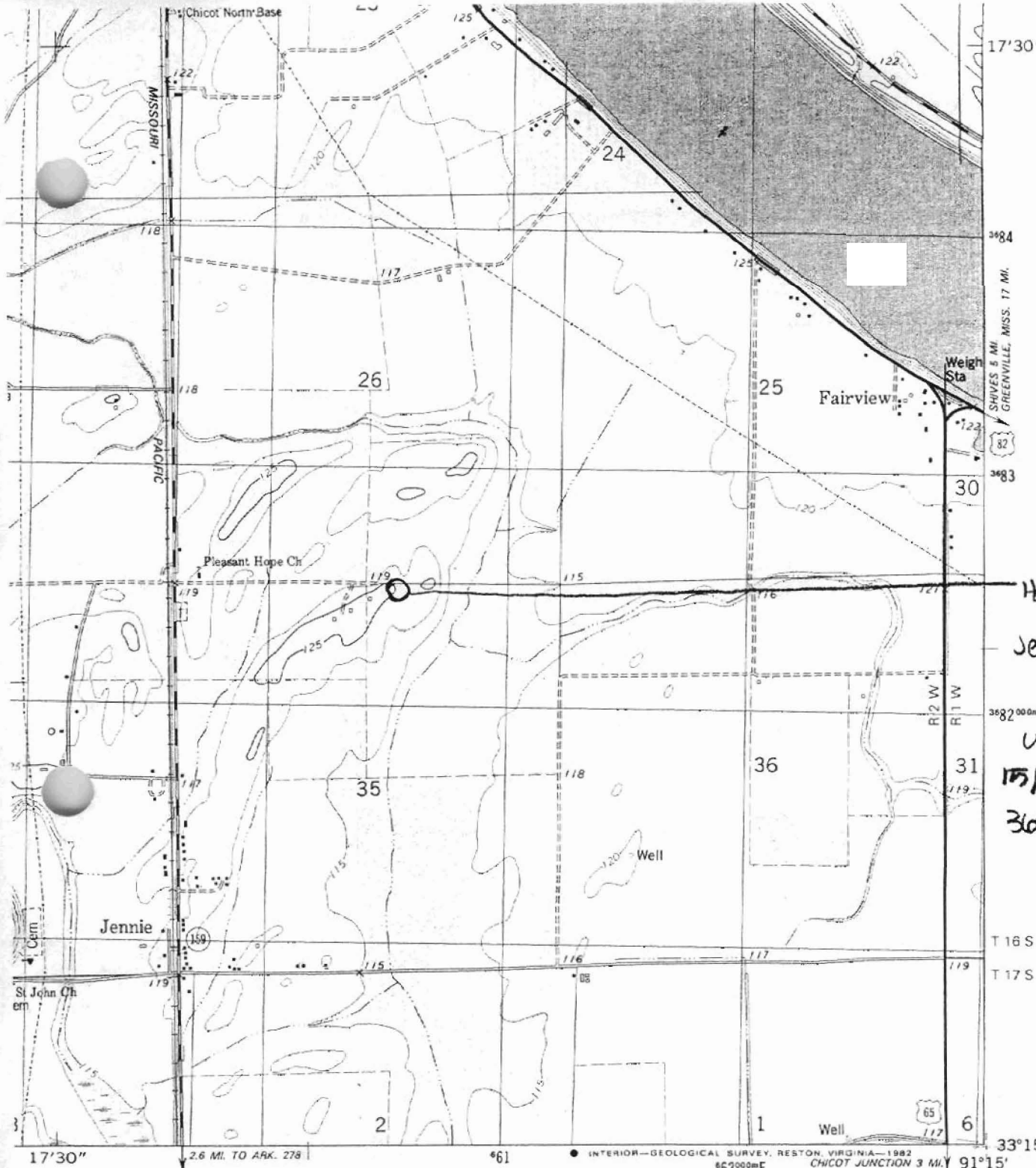

Harden  
Cemeteries  
Jennie, Chicot  
Co., AR  
UTM Reference:  
15/660454/  
3682736

17°30" 2.6 MI. TO ARK. 278

461 INTERIOR—GEOLOGICAL SURVEY, RESTON, VIRGINIA—1982  
62°00'00"E CHICOT JUNCTION 3 MI. EUDORA 10 MI. 91°15' 33°15'

**ROAD CLASSIFICATION**

- Primary highway, hard surface Light-duty road, hard or improved surface
- Secondary highway, hard surface Unimproved road
- Interstate Route U. S. Route State Route



**LAKE VILLAGE, ARK.**  
SE/4 LAKE VILLAGE 15' QUADRANGLE  
N3315-W9115/7.5

1981

DMA 7750 IV SE—SERIES V884

(EMMENCE)  
7750 II NW